

INSTALLATION GUIDE



C20-DL STRAIGHT PARTITION

Sprinter Partition (Perforated Window, No Access, Steel)



Scan the QR for the latest Install-Guide.





BEFORE YOU BEGIN

READ, UNDERSTAND, AND FOLLOW ALL WARNINGS AND INSTRUCTIONS BEFORE USING THIS PRODUCT. FAILURE TO FOLLOW THESE DIRECTIONS MAY RESULT IN PROPERTY DAMAGE, SERIOUS BODILY INJURY, AND/OR DEATH. RANGER DESIGN IS NOT RESPONSIBLE FOR ANY PROPERTY DAMAGE, PERSONAL INJURY, OR DEATH THAT OCCURRED WHILE USING ANY RANGER DESIGN PRODUCTS.



WARNING

- Failure to use Ranger Design-provided fasteners, brackets, and proper installation guidelines could increase risk of serious personal injury and/or death.
- If drilling is required to complete this installation: improper drilling can cause property damage to vehicles and could lead to electric shock, fire, or even death.
- If drilling is required to complete this installation: Ensure that drilling is only performed on areas of the vehicle allowed by the vehicle's Original Equipment Manufacturer's Body Builders Layout Book (or equivalent document).
- Prior to installation, inspect the vehicle to ensure that installation will not interfere with, or cause obstruction of, any critical components such as electrical wiring, fuel tanks, fuel-cells, locks, latches, etc.
- The installer or manufacturer is responsible for ensuring anchorages are installed onto suitable wall and floor structures; wall and floor strength must meet applicable performance requirements.
- Do not install systems into any weak or unsound materials such as plastics, woods, thin-walled metals, etc. without proper reinforcement.
- Do not install this product where it could interfere with the deployment of airbags. Failure to comply could result in death or serious injury.
- Do not install this product where it could ingress on the Transit Occupant Protection Zone. Failure to comply could result in death or serious injury.
- Incorrect installation could cause water leaks, electric shock or fire.
- Any cargo vehicle with any cargo or equipment should use a certified partition. See Ranger Design website for some partition options. (<https://rangerdesign.com/>)
- Mountings rails are recommended for any attachment to the vehicle walls.
- All items in the cargo area should be properly secured and partition doors closed while the vehicle is in motion.
- Check your vehicle's tare weight and remaining load capacity with all the equipment installed. Never exceed the maximum Gross Vehicle Weight Rating (GVWR), Gross Axle Weight Ratings (GAWRs), or other maximum loads permitted by the vehicle's Original Equipment Manufacturer (OEM) and required by law.
- The heaviest items must be placed towards the bottom of the vehicle, while the lightest ones can be arranged upwards. Vehicle cargo loading weight proportion should follow the following guidelines:

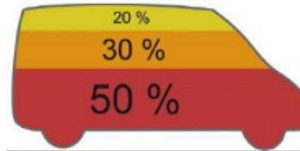

- The final alterer and/ or modifier should review the warning sheet with the customer before the vehicle is released to the customer or for general use. These instructions should remain with the vehicles a all times.
- Any modification or unintended use of this product voids any warranty and could create a hazardous condition.
- Ranger Design provides recommended assembly and installation instructions which should be followed to ensure correct operation. Failure to do so could result in invalidating the product's compliance, warranty and cause injury. Notwithstanding, the final stage vehicle alterer and/or modifier is responsible for the integration, installation, and compliance of the product in its final location to all applicable regulations and standards. Failure to maintain compliance of the vehicle to applicable regulations and standards could be punishable by law. Alterers and/or modifiers should consult with all local authorities prior to commissioning.



CAUTION

- If drilling is required to complete this installation. Before drilling, ensure that you will not hit any critical parts of the vehicle like the gas tank, wiring harness, or hose. Consult the vehicle OEM documentation as necessary. When drilling, use a drill collar to reduce the risk of damage to the vehicle.
- Any materials, padding, or glazing installed in the vehicle must comply with FMVSS/CMVSS 201/205/302, as applicable.
- In the event of a motor vehicle accident or collision where a Ranger system has been installed, especially ones where the vehicle structure is damaged and/or the air bags deploy and/or the vehicle has been towed, the system must be inspected to ensure continued soundness and safety before returning the vehicle to service. Damaged components should be replaced as necessary.
- All system components should be regularly inspected, cleaned, and maintained pursuant to Ranger guidelines.

QUICK START GUIDE

Phase 1 - Assembly

❑ 1.1 Setup.....	4
❑ 1.2 Partition assembly.....	10

Phase 2 - Installation

❑ 2.1 Tips on how to attach a plusnut.....	8
❑ 2.2 Vehicle preparation.....	9
❑ 2.3 Straight partition installation.....	10

REQUIRED ITEMS

- ❑ Cordless Impact
- ❑ Cordless Drill
- ❑ Cutter
- ❑ Mallet
- ❑ Plusnut Tool
- ❑ Tape Measure
- ❑ T40 Torque Bit
- ❑ 3/8" Drill Bit
- ❑ 7/16" Socket
- ❑ 1/2" Socket
- ❑ 9/16" Wrench
- ❑ Rivet Gun
- ❑ 3/16" Driver Bit
- ❑ Drill Stop
- ❑ 1" Hole Saw

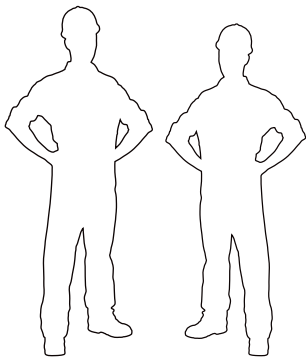

2
PERSONS

PHASE 1 – ASSEMBLY

1.1 SETUP

1.1.1 Unpack components; compare with the bill of materials.

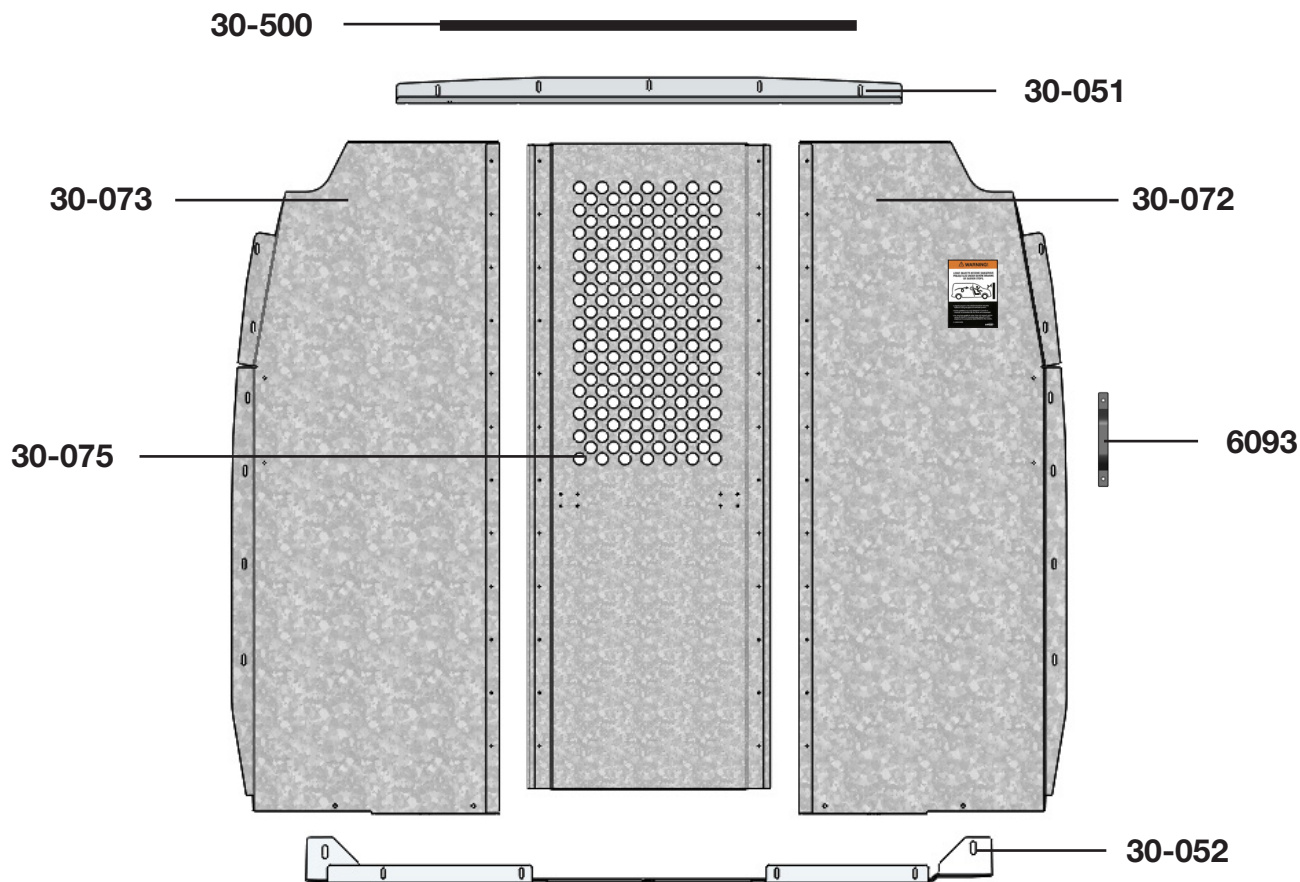

1.1.2 Verify all parts are present.

Item No.	Description	Qty.
30-051	Top Bracket	1
30-052	Floor Bracket	1
30-072	Passenger Side Panel	1
30-073	Driver Side Panel	1
30-075	Perforated Panel	1
30-500	Edge Trim (QTY in Inches)	45
6093	Grab Handle	1
79-932	Warning Label (Bilingual)	1
94-3003	Assembly Fastener Bag	1
94-6093	Assembly Fastener Bag	1
96-3001	Installation Fastener Bag	1

1.1.3 Identify the **Assembly** and **Installation** fastener bags.

94-3003 Fastener Bag

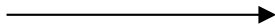

Hardware Assembly

4x

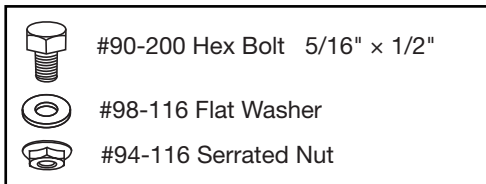

4x

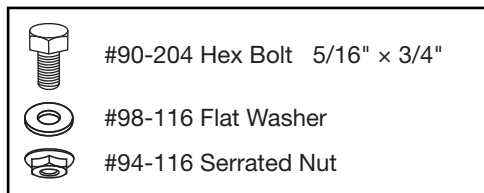

24x

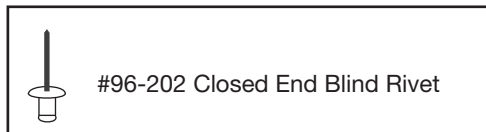

96-3001 Fastener Bag

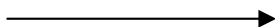

Hardware Assembly

5x



6x

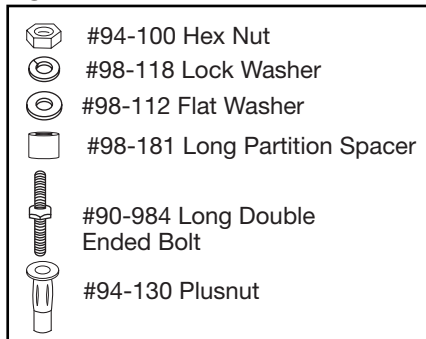

6x



PHASE 1 – ASSEMBLY

1.2 PARTITION ASSEMBLY

1.2.1 Remove all the PVC from all the parts, then attach the edge trims on these locations.

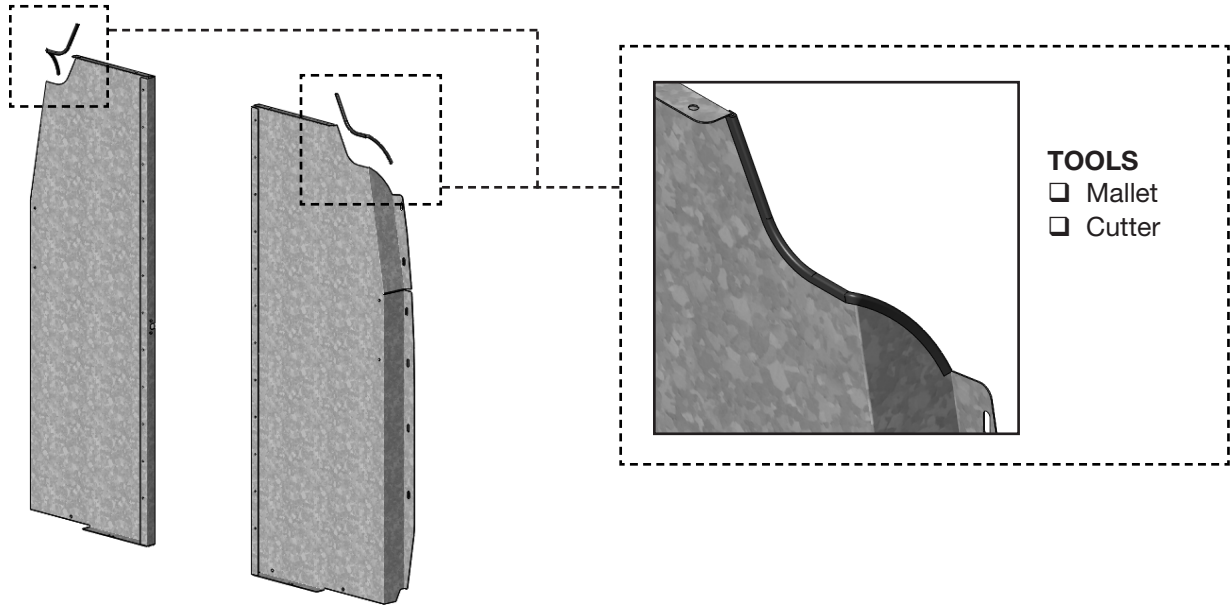

1.2.2 Attach the driver and passenger side panels to the perforated panel.

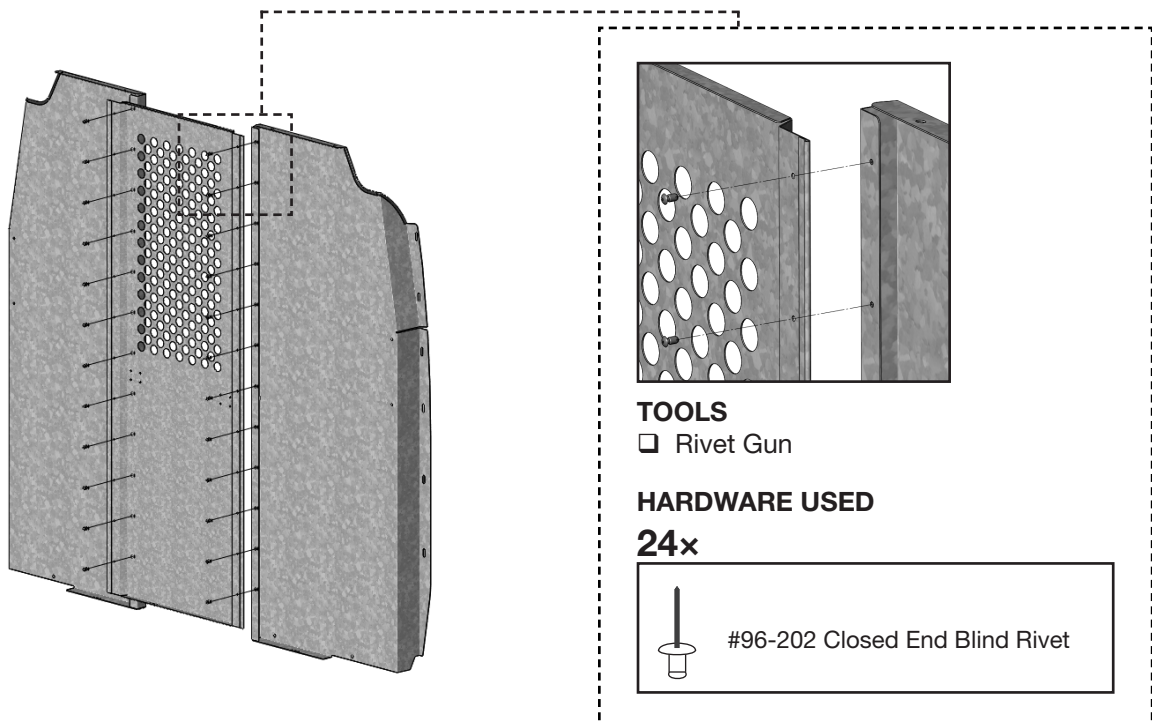

1.2.3 Attach the grab handle on the passenger side panel.

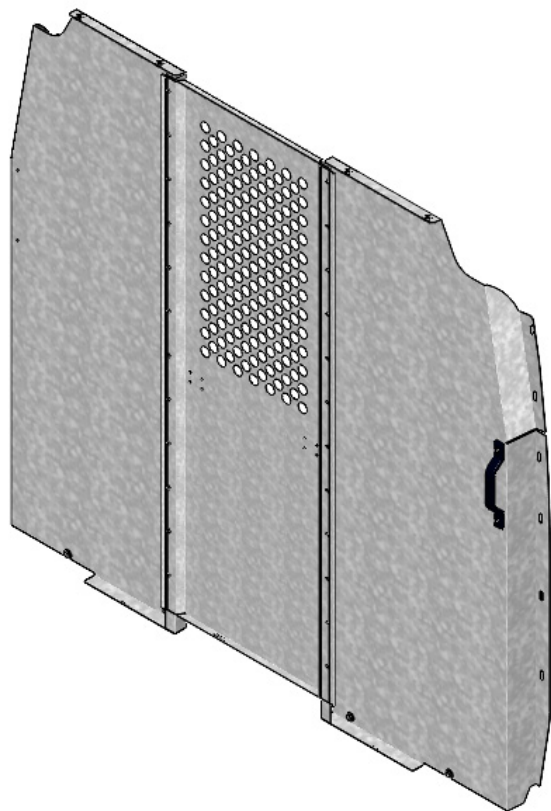

For proper installation of the grab handle visit rangerdesign.com or scan the QR code for instructions.



1.2.4 Attach the top bracket to the driver and passenger side panels.

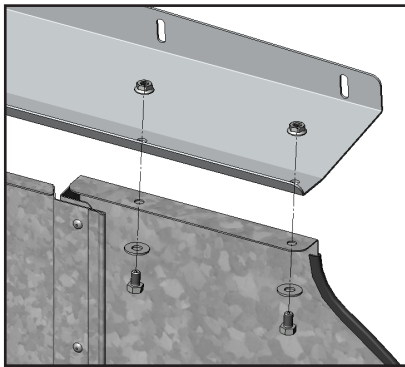
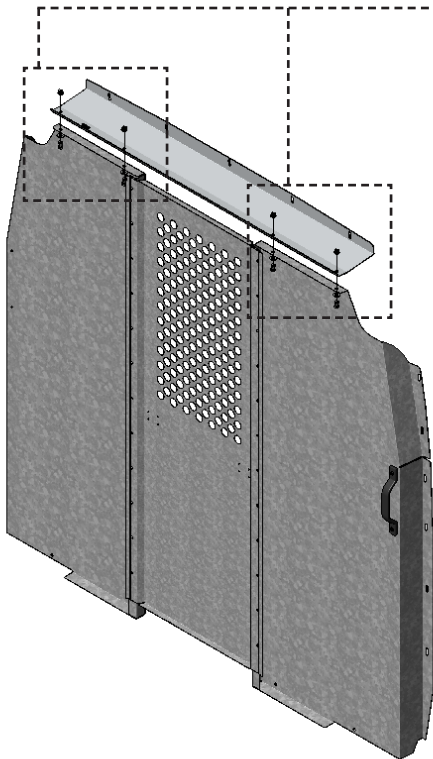

TOOLS

- Cordless Impact
- 1/2" Socket

HARDWARE USED

4x



#90-200 Hex Bolt 5/16" x 1/2"



#98-116 Flat Washer



#94-116 Serrated Nut

PHASE 2 – INSTALLATION

2.1 TIPS ON HOW TO ATTACH A PLUSNUT

2.1.1 Attach the plusnut using the plusnut gun.

TIPS: Put the plusnut on the plusnut gun, then attach the plusnut in the hole by turning the gun forward until the plusnut locks, then remove the gun by turning in reverse.

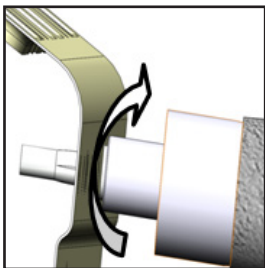

FORWARD

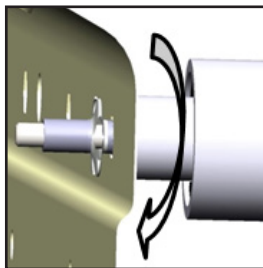

REVERSE



2.1.2 Attach the plusnut using the 6490 plusnut tool.

NOTE: The hardware used for the 6490 plusnut tool is not included in the fastener bag. The 6490 plusnut tool can be ordered separately upon demand at no charge.

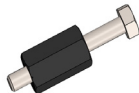
6490



HARDWARE USED

-  Flat washer 1/4"
-  Flat washer 1/4" BS x 3/4" OD

TOOLS

- ☐ Cordless Impact
- ☐ 7/16" Socket
- ☐ 9/16" Wrench

TIPS STEP 1:

Assemble the 6490 plusnut tool with the hardware needed, plusnut and the 9/16" wrench as shown.



TIPS STEP 2:

Attach the plusnut in the hole by turning the bolt forward using an impact with a 7/16" socket until the plusnut locks, then remove the bolt by turning the impact in reverse.

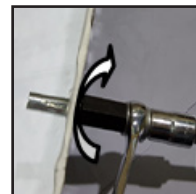

FORWARD



REVERSE

PHASE 2 – INSTALLATION

2.2 VEHICLE PREPARATION

2.2.1 Attaching plusnuts.

NOTE: Put the partition in place and check if the holes of the partition align with the holes of the van.

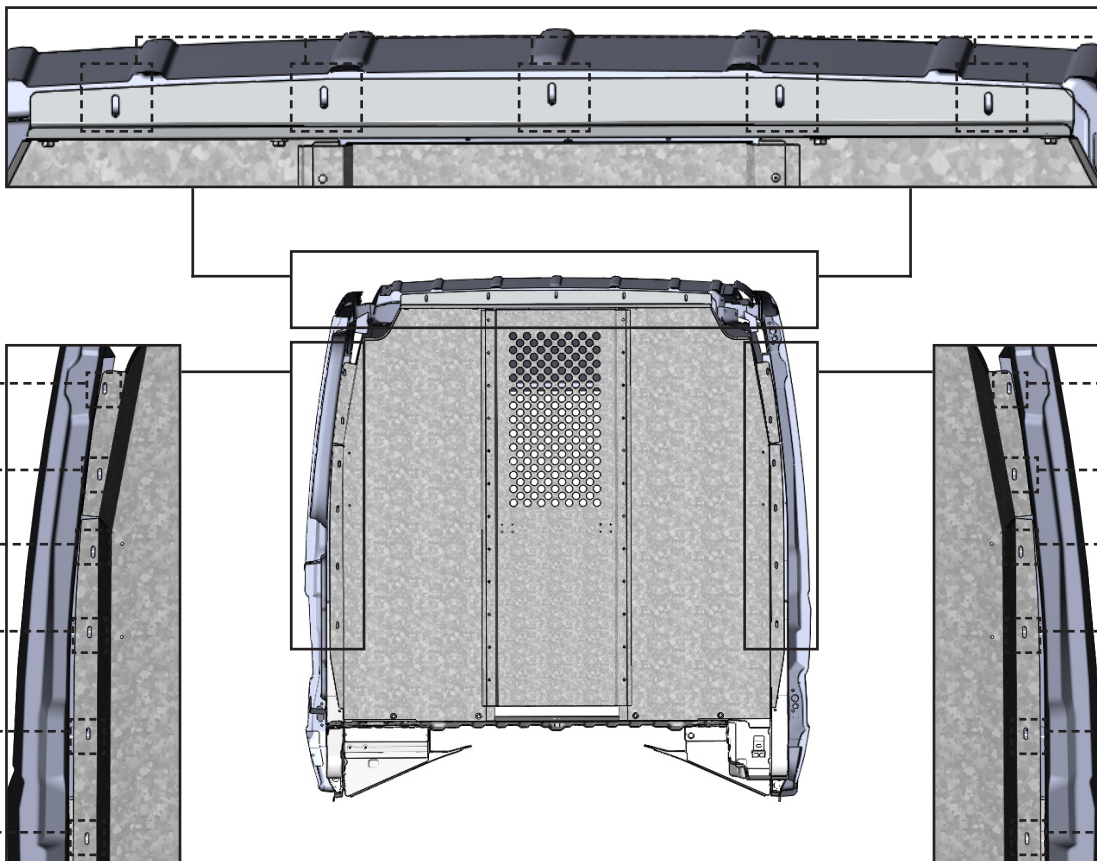

Put the assembled partition in place, then mark all the holes through the van.

- NOTE:**
- For the B-pillar plastic cover and wood floor use 1" hole saw to drill a hole in the B-pillar plastic cover or wood floor, then drill 3/8" hole in the van.
 - Enlarge all the holes in the van that align with the holes of the partition using 3/8" drill bit or step drill.

TOOLS

- ☐ Cordless Drill
- ☐ 3/8" Drill Bit or Step Drill
- ☐ 1" Hole Saw
- ☐ Drill Stop



Attach plusnuts in the 15 holes.

TOOLS

- ☐ Plusnut Tool

HARDWARE USED

17x



94-130
Plusnut .250

2.2.2 Floor preparation.

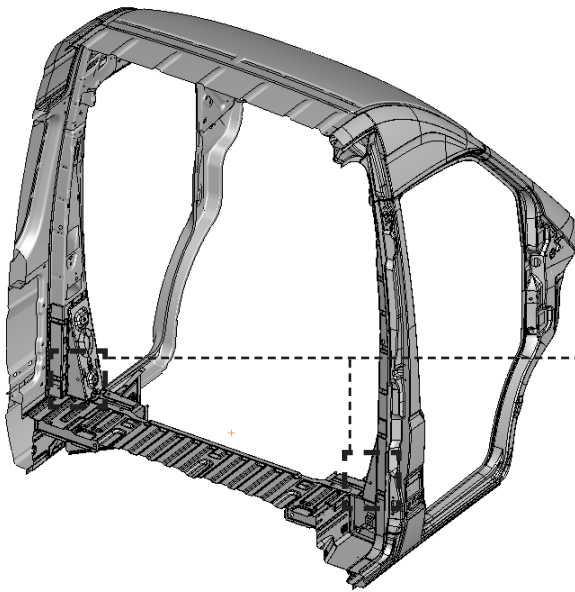

Remove the two D-rings in the pillars, for re-use.



TOOLS

- ❑ Cordless Impact
- ❑ T40 Torque Bit

PHASE 2 – INSTALLATION

2.3 STRAIGHT PARTITION INSTALLATION

2.3.1 Floor bracket installation.

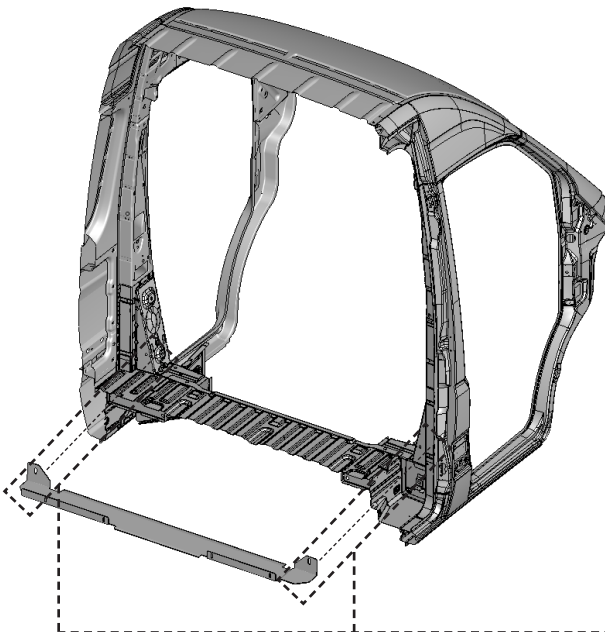

Attach the floor bracket to the floor re-using the 2 D-ring bolts.



TOOLS

- ❑ Cordless Impact
- ❑ T40 Torque Bit

HARDWARE USED

2x

Use the D-ring bolt

2.3.2 Put the assembled partition back in place, then bolt the driver and passenger side panels to the van.

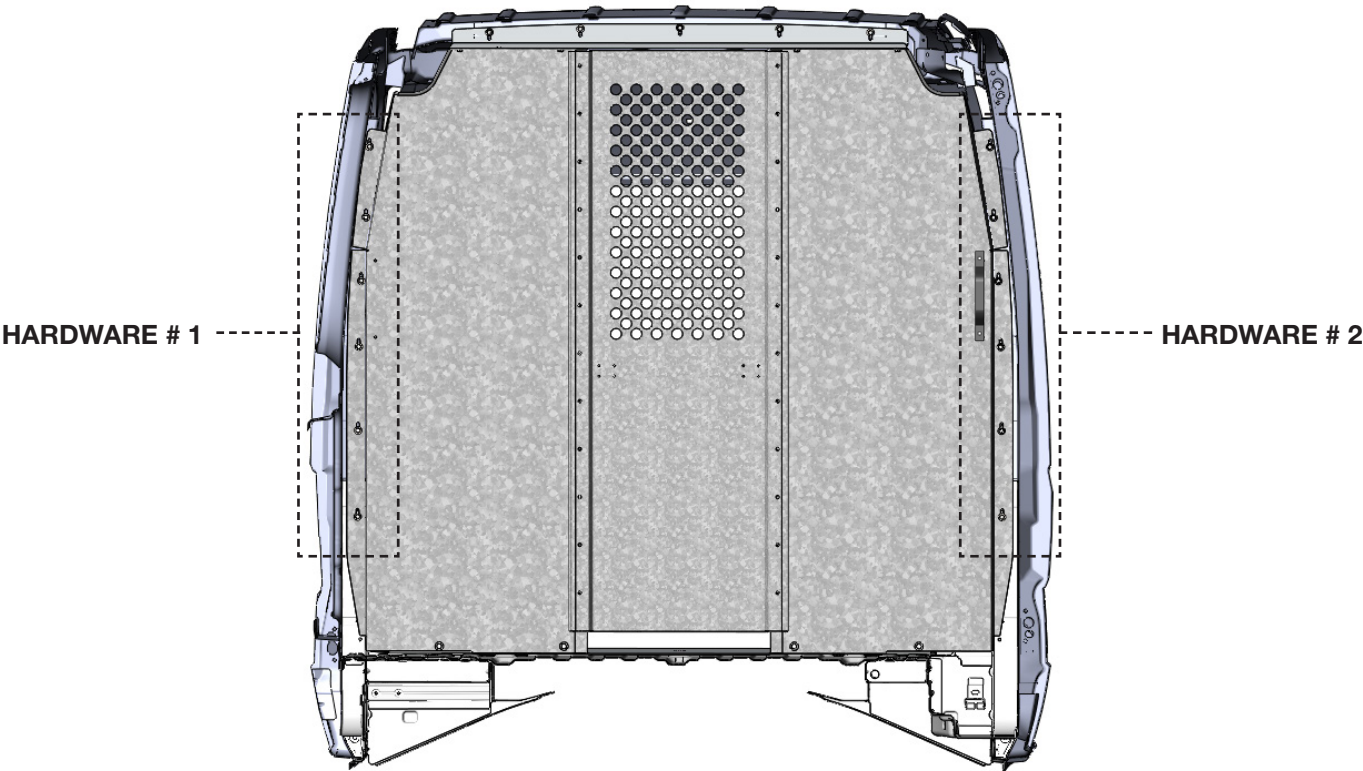

HARDWARE # 1

TOOLS

- ☐ Cordless Impact
- ☐ 7/16" Socket

HARDWARE USED

6x

#98-181 Short Partition Spacer

#90-984 Double Ended Bolt

#94-130 Plusnut

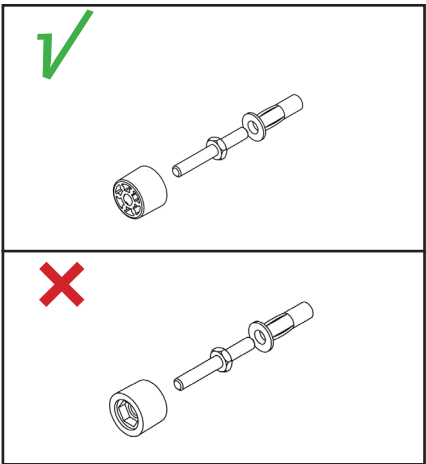

HARDWARE # 2

TOOLS

- ☐ Cordless Impact
- ☐ 7/16" Socket

HARDWARE USED

6x

#98-180 Short Partition Spacer

#90-983 Double Ended Bolt

#94-130 Plusnut

2.3.2 Put the side panels in place, then bolt the driver and passenger side panels to the van.

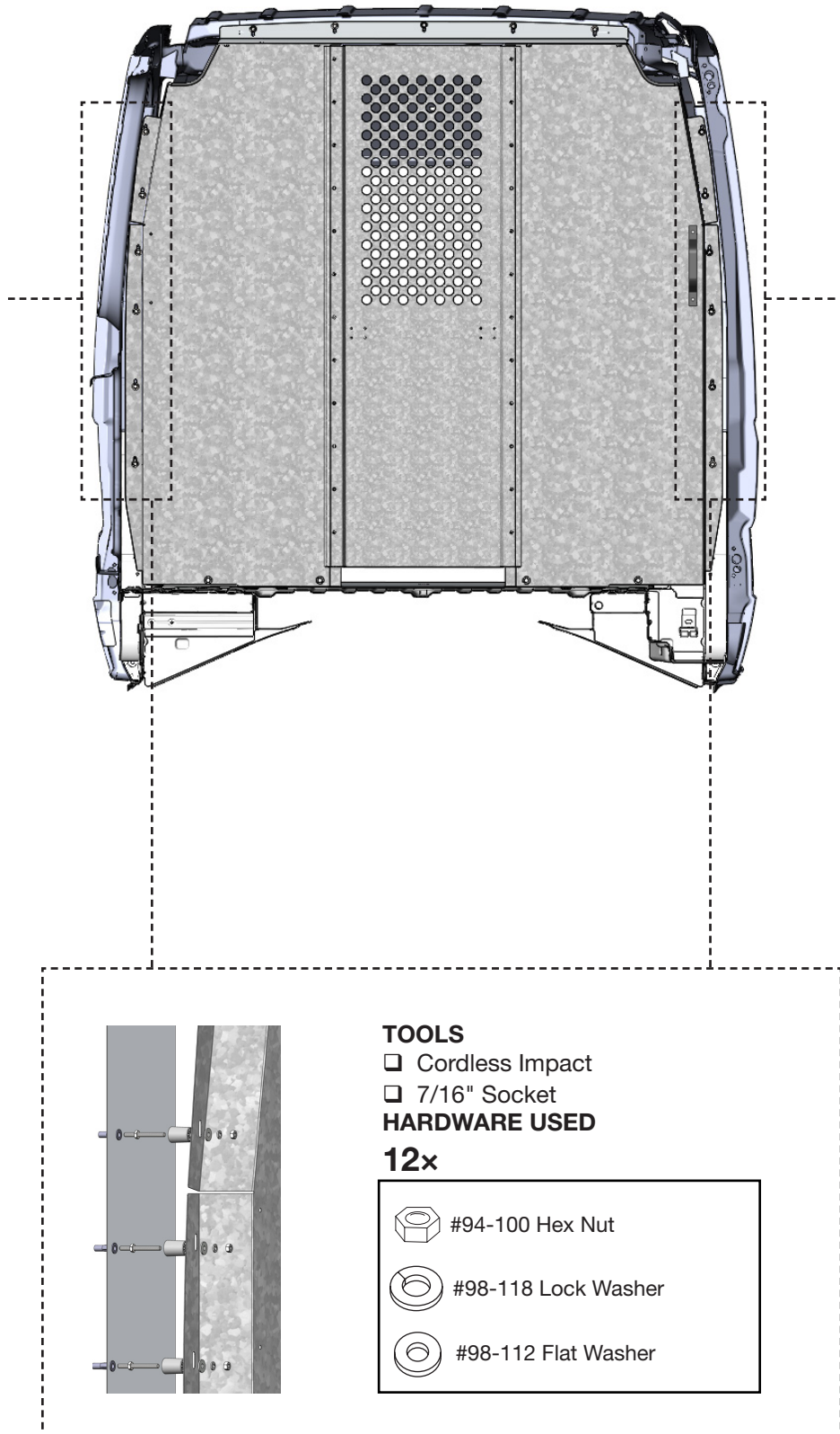

2.3.3 Attach the top bracket to the van.

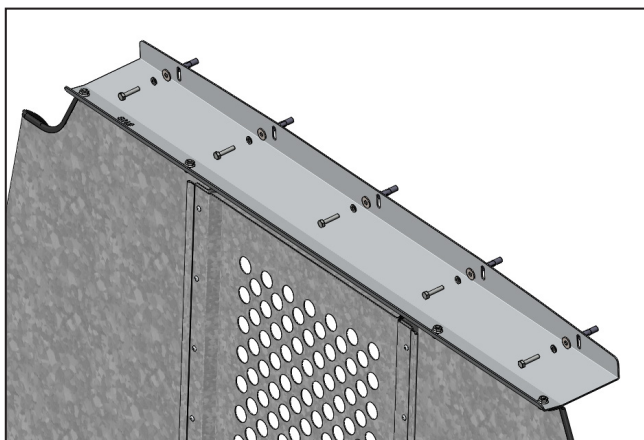
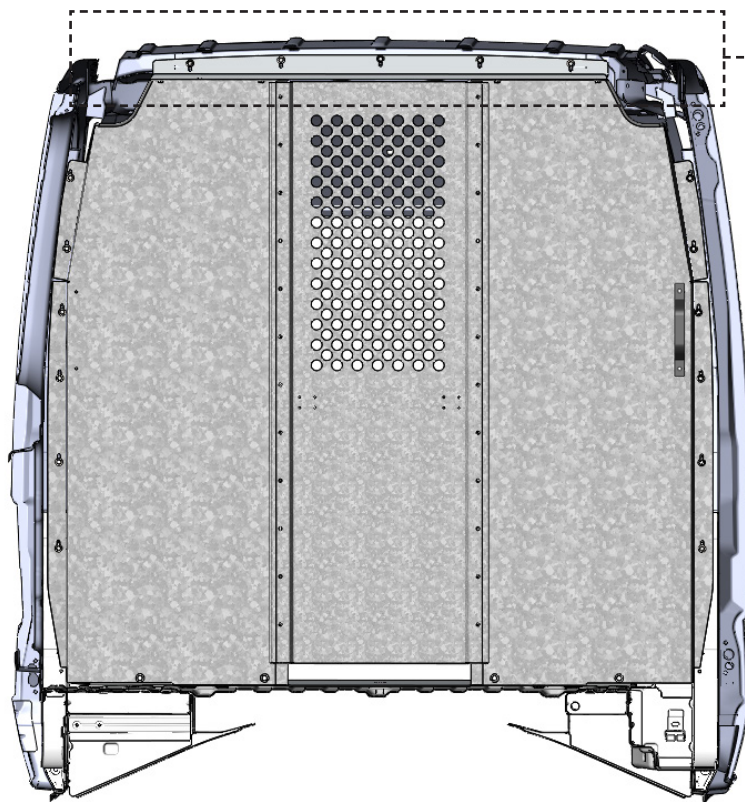

TOOLS

- Cordless Impact
- 7/16" Socket

HARDWARE USED

5x



#90-118 Hex Bolt 1/4" x 1-1/4"



#98-118 Lock Washer



#98-112 Flat Washer

2.3.4 Attach the driver and passenger side panels to the floor bracket.

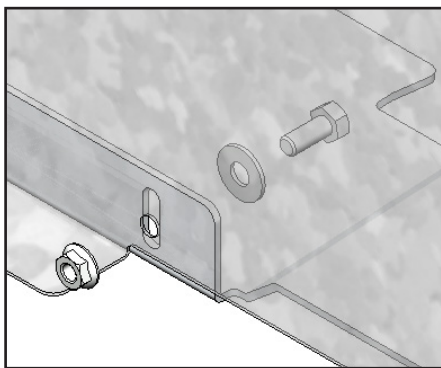
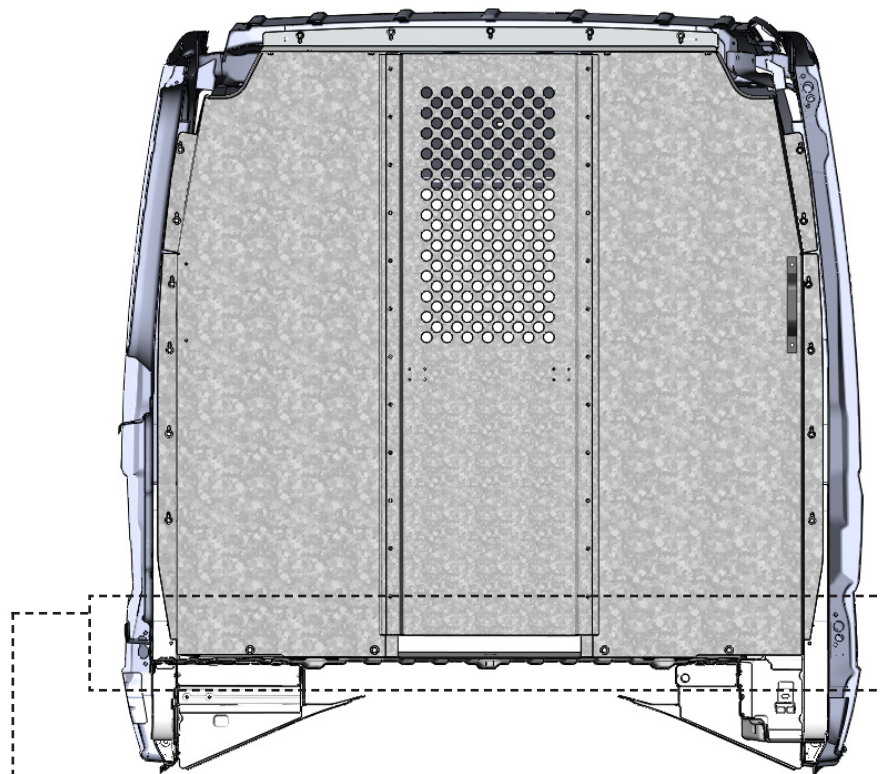

TOOLS

- ☐ Cordless Impact
- ☐ 1/2" Socket

HARDWARE USED

4x



#90-204 Hex Bolt 5/16" x 3/4"



#98-116 Flat Washer



#94-116 Serrated Nut

2.3.5 Apply the warning label on the passenger side panel.

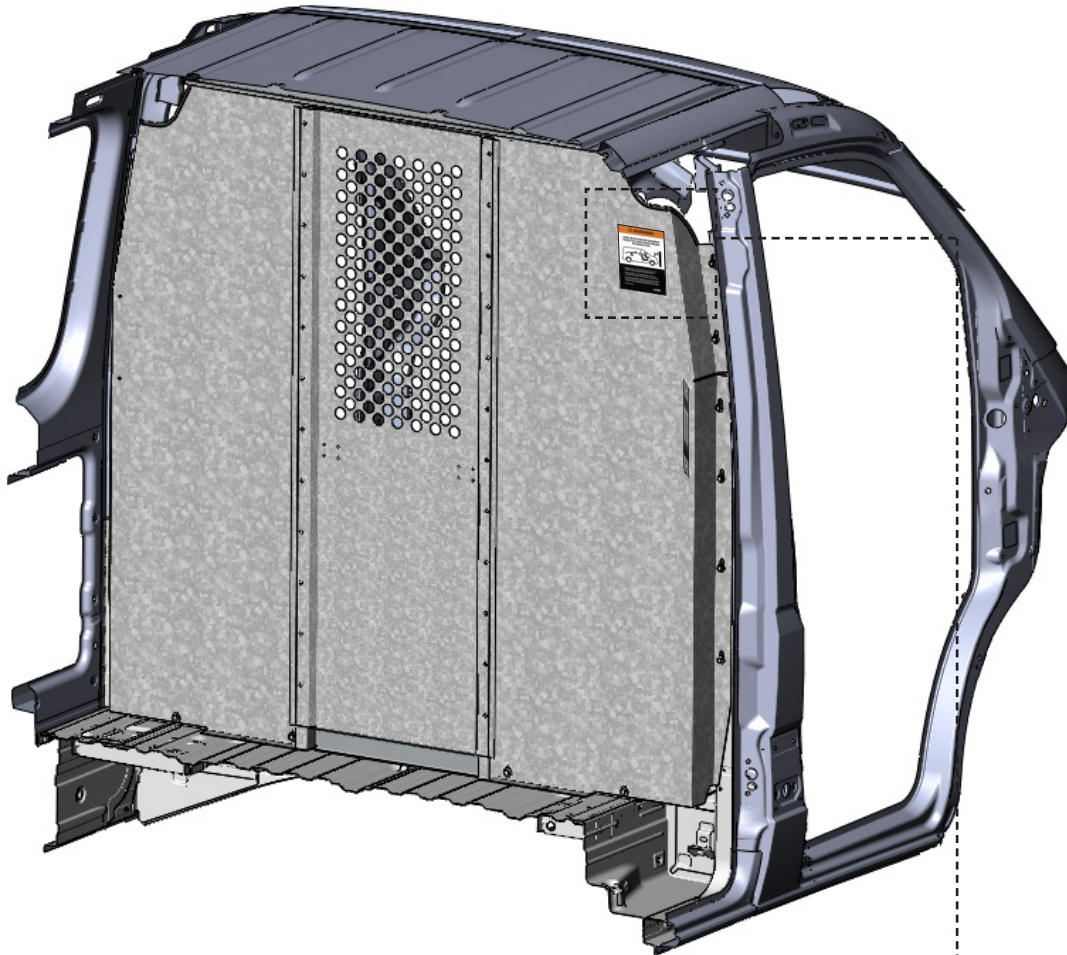

NOTE: English warning label is already attached on the passenger panel.

**“Congratulations, you have successfully installed your
Straight Partition!”**

Thank you for doing business with us.”