

INSTALLATION GUIDE

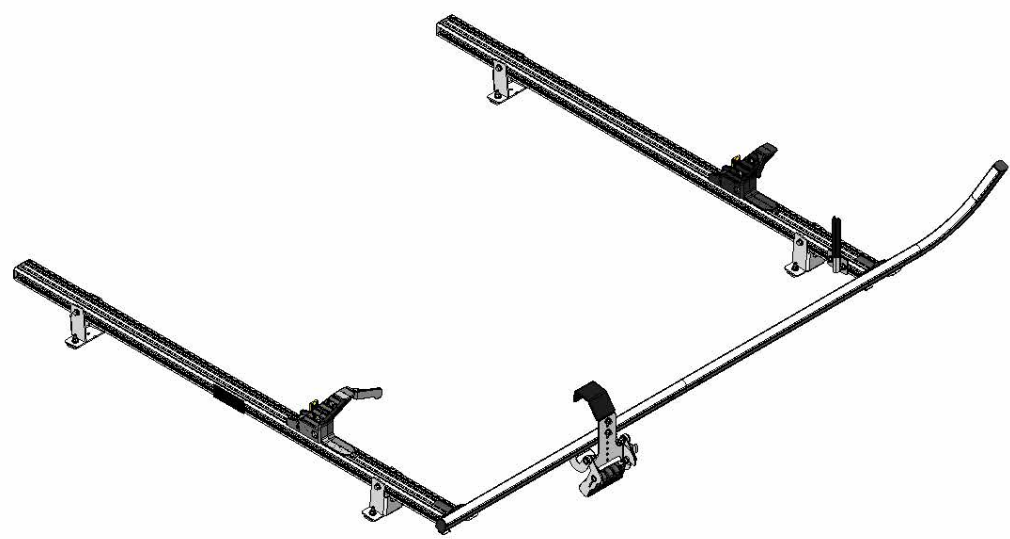

Clamp Rack 16-UCL77



Scan the QR for the latest Install-Guide.

For technical support, contact us at 1-800-565-5321

16-UCL77 Installation Guide | REV. E2 |

SET-UP - BOM & TOOLS

Item No.	Description	Qty.
16-010	Rung Stopper	1
16-012	Crossbar-to-ski mount	2
16-013	Ladder Holder	2
16-0005	Long Straight Ski	1
16-0006	Front Ski	1
16-0007	Throttle Latch	1
16-0008	Ladder Hook (Passenger Front, Driver Rear)	1
16-0009	Ladder Hook (Passenger Rear, Diver Front)	1
94-1600	Customer Assembly Fastener Kit	1
96-1600	Customer Install Fastener Kit	1

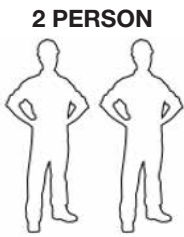

REQUIRED ITEMS

- ☐ Ratchet 2x
- ☐ 1/2" Wrench
- ☐ 1/2" Socket 2x
- ☐ 3/16" Drive Hex Bit Socket
- ☐ Cordless Impact
- ☐ Knife
- ☐ Tape Measure
- ☐ Marker
- ☐ Ladder

NOTE: Crossbars, feet and necessary hardware are not included in this kit.

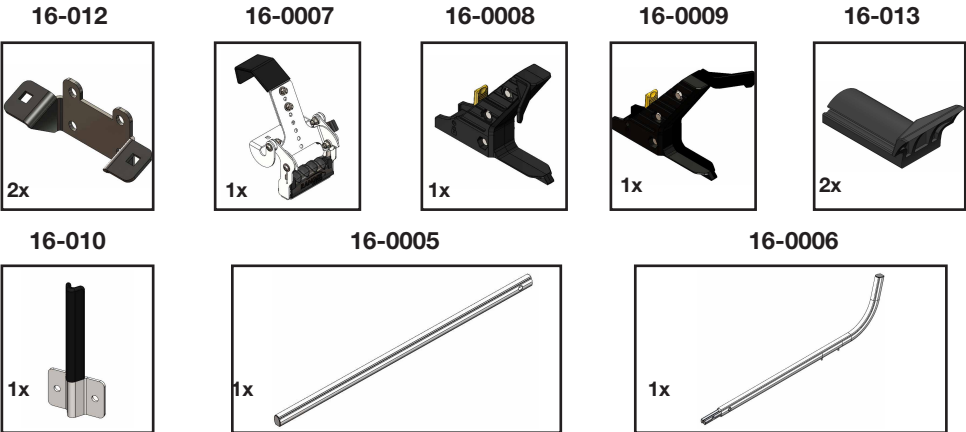

STEP 1 - SLIDE LADDER HOOK TO CROSSBARS

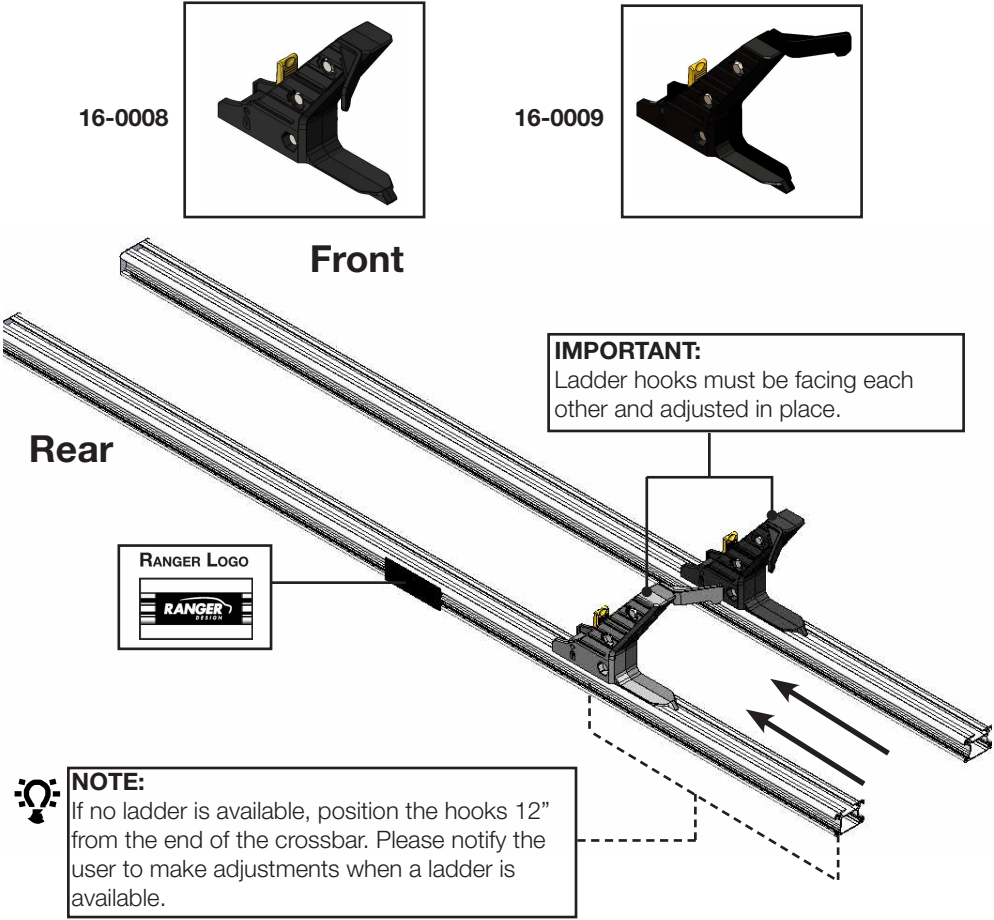

STEP 2 - ATTACH FEET TO CROSSBARS

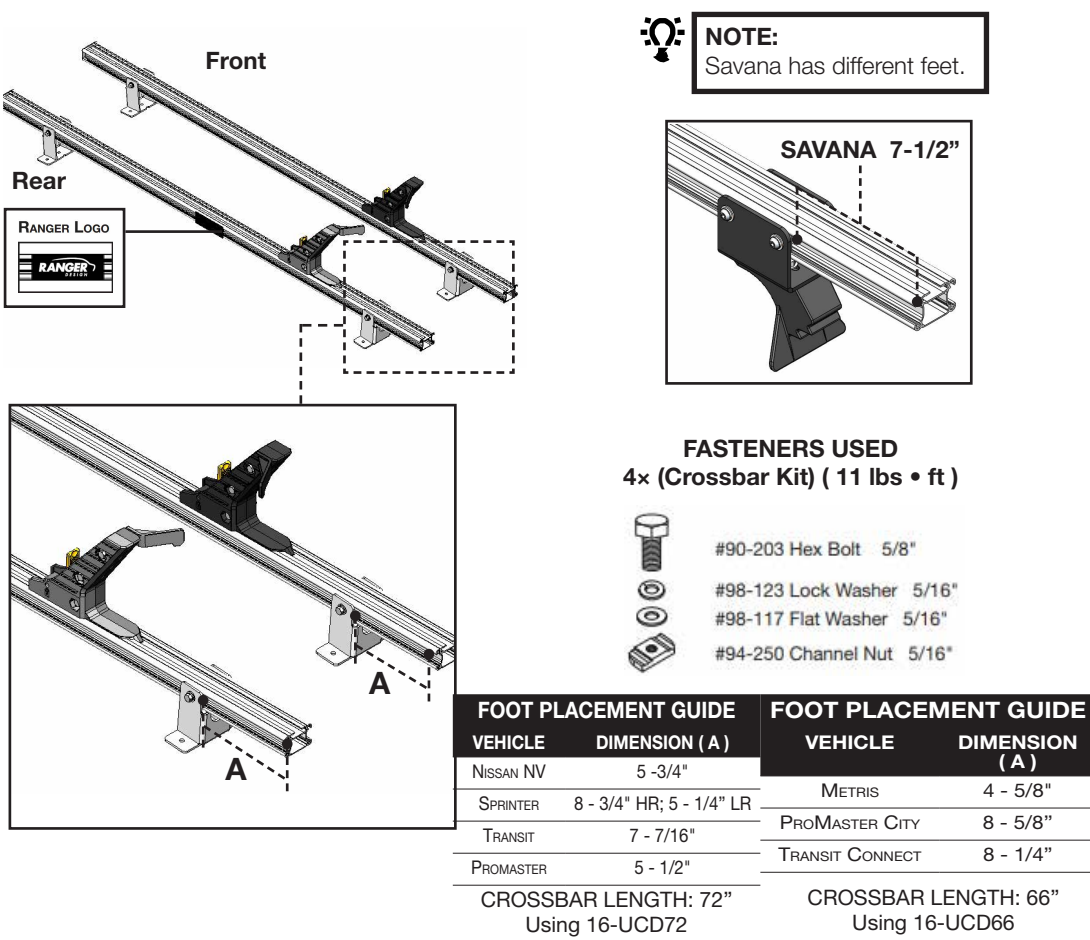

STEP 3 - ATTACH RUNG STOPPER TO CROSSBAR

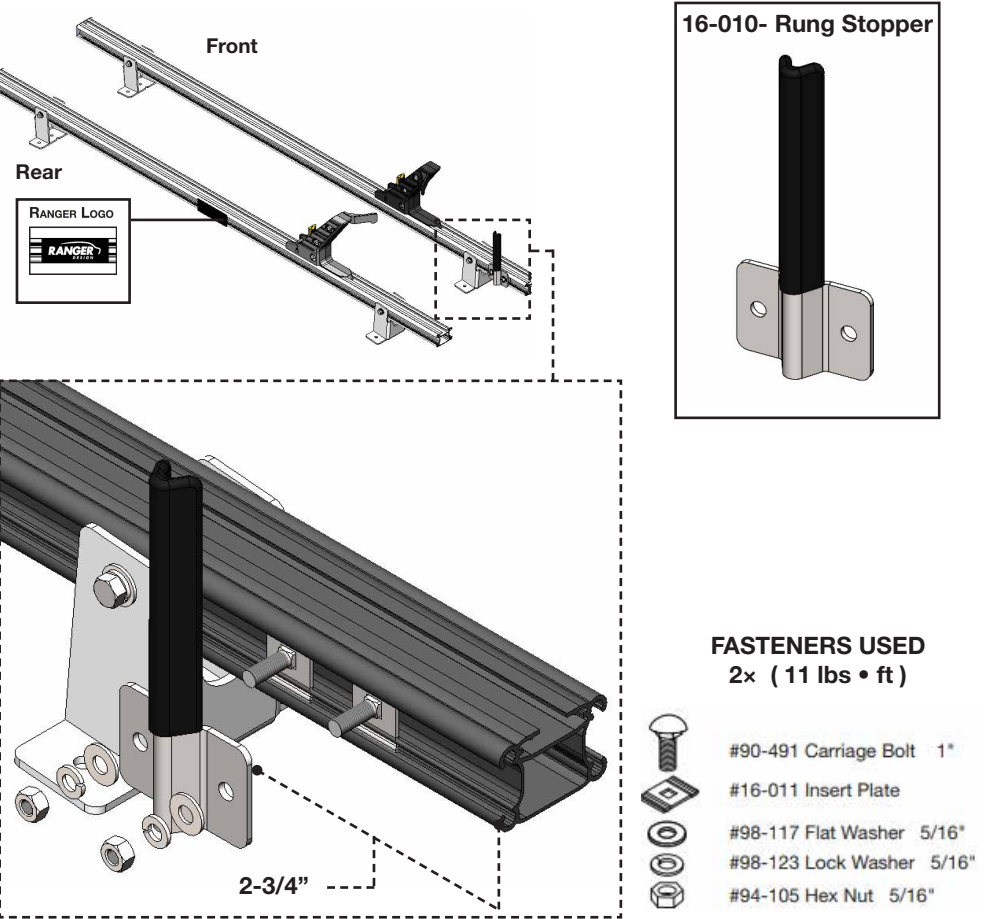

STEP 4 - ATTACH CROSSBAR-TO-SKI MOUNT

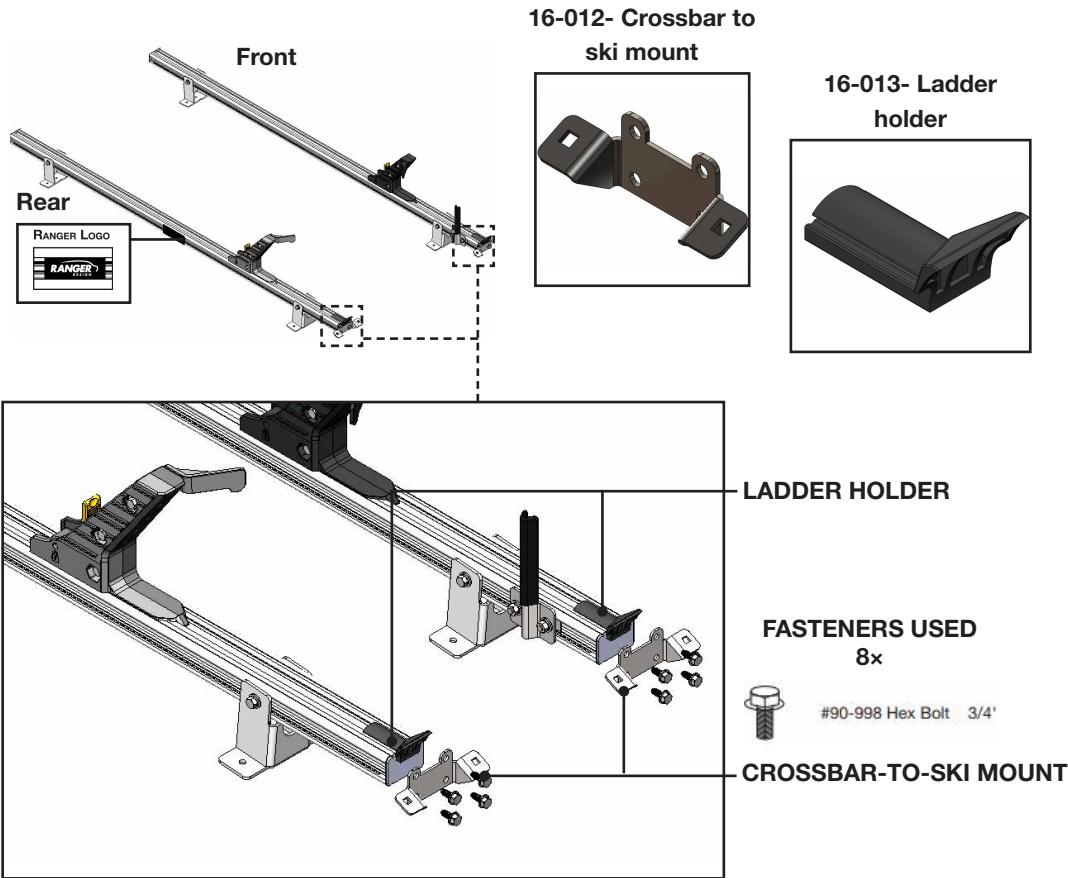

STEP 5 - 2 PIECE SKI ASSEMBLY

Slide 4 carriage bolts to the bottom of long straight ski.

90-491

Connect the long straight ski to the front ski, then bolt them together.

NOTE:

- If you have 3rd crossbar, slide 2 carriage bolts to the bottom of the front ski before connecting both skis.

IMPORTANT: Install 2 washers under the bolt head.

FASTENERS USED
1x (11 lbs • ft)

- #90-211 Hex Bolt 1 - 1/8"
- #98-117 Flat Washer 5/16"
- #98-117 Flat Washer 5/16"
- #98-117 Flat Washer 5/16"
- #94-251 Low Profile Lock Nut 5/16"

STEP 6 - ATTACH SKI TO CROSSBAR

Front

Rear

USE THESE BOLTS

DO NOT USE these 2 bolts in this step.

65" RECOMMENDED

FASTENERS USED
4x (11 lbs • ft)

- #90-491 Carriage Bolt 1"
- #98-117 Flat Washer 5/16"
- #98-123 Lock Washer 5/16"
- #94-105 Hex Nut 5/16"

STEP 7 - ATTACH THROTTLE LATCH

16-0007

Front

Rear

RANGER LOGO

APPROXIMATELY 10"

FASTENERS USED
2x (11 lbs • ft)

- #90-491 Carriage Bolt 1"
- #98-117 Flat Washer 5/16"
- #98-123 Lock Washer 5/16"
- #94-105 Hex Nut 5/16"

STEP 8 - ATTACH LADDER RACK

65" RECOMMENDED

FASTENERS USED
4x (Per Crossbar)
(11 lbs • ft)

- #94-105 Hex Nut 5/16"
- #98-123 Lock Washer 5/16"
- #98-117 Flat Washer 5/16"

FOR SAVANA

FASTENERS USED
2 x Per Crossbar (17 ft • lbs)

- #90-327 Hex Bolt 3/8" x 2-1/2"
- #98-109 Flat Washer
- #10-411 Gutter Clip
- #10-602 Rubber Mat
- #10-447 Feet
- #94-109 Lock Nut

STEP 9 - INSTALL

Load the ladder in the ladder rack, then place the hooks and throttle latch in the right position and tighten all the bolts.

FLUSH

Interior Windshield

NOTE:
Verify that the label doesn't block the driver's visibility while driving.

Write the height of the vehicle with the Clamp rack here.

THE OVERALL HEIGHT OF THIS VEHICLE INCLUDING THE LADDER RACK IS APPROXIMATELY:

PLEASE ENSURE CLEARANCE AND DRIVE SLOWLY UNDER LOW HANGING OBJECTS

RANGER DESIGN

For technical support, contact us at 1-800-565-5321

HOOK ADJUSTMENTS

NOTE:
See User Manual for more Hook Adjustment details.

• Move the ladder hook until it touches the ladder.

• The rung stopper must be inside the ladder, then tighten the bolts in the rung stopper.

• Verify that the throttle latch is not hitting the ladder rack or the ladder rung, then tighten the nuts under the throttle latch.



BEFORE YOU BEGIN

READ, UNDERSTAND, AND FOLLOW ALL WARNINGS AND INSTRUCTIONS BEFORE USING THIS PRODUCT. FAILURE TO FOLLOW THESE DIRECTIONS MAY RESULT IN PROPERTY DAMAGE, SERIOUS BODILY INJURY, AND/OR DEATH. RANGER DESIGN IS NOT RESPONSIBLE FOR ANY PROPERTY DAMAGE, PERSONAL INJURY, OR DEATH THAT OCCURRED WHILE USING ANY RANGER DESIGN PRODUCTS.



WARNING

- Failure to use Ranger Design-provided fasteners, brackets, and proper installation guidelines could increase risk of serious personal injury and/or death.
- If drilling is required to complete this installation: improper drilling can cause property damage to vehicles and could lead to electric shock, fire, or even death.
- If drilling is required to complete this installation: Ensure that drilling is only performed on areas of the vehicle allowed by the vehicle's Original Equipment Manufacturer's Body Builders Layout Book (or equivalent document).
- Prior to installation, inspect the vehicle to ensure that installation will not interfere with, or cause obstruction of, any critical components such as electrical wiring, fuel tanks, fuel-cells, locks, latches, etc.
- The installer or manufacturer is responsible for ensuring anchorages are installed onto suitable wall and floor structures; wall and floor strength must meet applicable performance requirements.
- Do not install systems into any weak or unsound materials such as plastics, woods, thin-walled metals, etc. without proper reinforcement.
- Do not install this product where it could interfere with the deployment of airbags. Failure to comply could result in death or serious injury.
- Incorrect installation could cause water leaks, electric shock or fire.
- Any cargo vehicle with any cargo or equipment should use a certified partition. See Ranger Design website for some partition options. (<https://rangerdesign.com/>)
- Mountings rails are recommended for any attachment to the vehicle walls.
- All items in the cargo area should be properly secured and partition doors closed while the vehicle is in motion.
- Check your vehicle's tare weight and remaining load capacity with all the equipment installed. Never exceed the maximum Gross Vehicle Weight Rating (GVWR), Gross Axle Weight Ratings (GAWRs), or other maximum loads permitted by the vehicle's Original Equipment Manufacturer (OEM) and required by law.
- The heaviest items must be placed towards the bottom of the vehicle, while the lightest ones can be arranged upwards. Vehicle cargo loading weight proportion should follow the following guidelines:

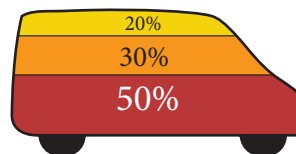

- The final alterer and/ or modifier should review the warning sheet with the customer before the vehicle is re-leased to the customer or for general use. These instructions should remain with the vehicles a all times.
- Any modification or unintended use of this product voids any warranty and could create a hazardous condition.
- Ranger Design provides recommended assembly and installation instructions which should be followed to ensure correct operation. Failure to do so could result in invalidating the product's compliance, warranty and cause injury. Notwithstanding, the final stage vehicle alterer and/or modifier is responsible for the integration, installation, and compliance of the product in its final location to all applicable regulations and standards. Failure to maintain compliance of the vehicle to applicable regulations and standards could be punishable by law. Alter-ers and/or modifiers should consult with all local authorities prior to commissioning.



CAUTION

- If drilling is required to complete this installation. Before drilling, ensure that you will not hit any critical parts of the vehicle like the gas tank, wiring harness, or hose. Consult the vehicle OEM documentation as necessary. When drilling, use a drill collar to reduce the risk of damage to the vehicle.
- Any materials, padding, or glazing installed in the vehicle must comply with FMVSS/CMVSS 201/205/302, as applicable.
- In the event of a motor vehicle accident or collision where a Ranger Design system has been installed, especial-ly ones where the vehicle structure is damaged and/or the air bags deploy and/or the vehicle has been towed, the system must be inspected to ensure continued soundness and safety before returning the vehicle to service. Damaged components should be replaced as necessary.
- All system components should be regularly inspected, cleaned, and maintained pursuant to Ranger guidelines.