

DISTRIBUTOR BULLETIN

January 2016

New people have joined the Ranger team or have changed positions.

We are pleased to introduce them to you:

- ▶ **Rick Pilgrim** is now Regional Sales Manager for Canada
- ▶ **Blair Cowie** is now HR Support Specialist
- ▶ **Andreas Pollmueller** is now Head of Marketing & Business Development
- ▶ **Katie Stearns** is HR Support Specialist
- ▶ **Ivan Sapla** is Marketing Coordinator
- ▶ **Branden Symington** is now at Reception, Canada
- ▶ **Lise Bellemare** is Inside Sales and Customer Service Representative
- ▶ **Teresa Muro** is Executive Assistant
- ▶ **Jay Bowie** is now Inside Sales and Customer Service Representative



"I'm looking forward to this new challenge to help Ranger achieve its world-class goals"

Andreas Pollmueller
Head of Marketing & Business Development

Andreas Pollmueller is a Marketing Executive with 25 years of marketing, sales and business development experience in the manufacturing and consumer goods industry.

andreas.pollmueller@rangerdesign.com



Rick Pilgrim
Regional Sales Manager for Canada

Rick Pilgrim has worked at Ranger Design in the Marketing Department since 2013. In his new role as Regional Sales Manager for Canada, Rick will be supporting and working with our Canadian Distributors to develop new business strategies together.

rick.pilgrim@rangerdesign.com

NTEA 2016

March 1st to 4th, 2016

We are pleased to invite you to visit us at our booth # 5759.

[Register now! ▶](#)



2016 Buyers' Guide

Available
January 2016!

To pre-order this catalog, please contact cs@rangerdesign.com.

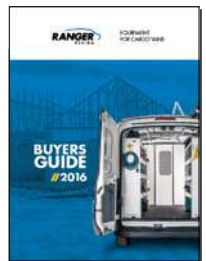

Sprinter Ladder Racks & Max Racks

Mounting tracks launched
January 1st, 2016

Sprinter ladder racks & Max Racks come standard with mounting tracks as of January 1st, 2016.

Pricing reflects the ladder rack and the mounting track as a combined product.



Ranger Academy Product Sales Training in SoCal

Ranger Design will be kicking off Ranger Academy with a mid-February sales training seminar in Southern California. This training is designed for salespeople and will demonstrate how to quote and effectively sell our Ranger products. Space is limited, so please inquire for more information at cs@rangerdesign.com.



NV200/City Express Shelving

As of January 1st, 2016 the NV200/City Express shelving come standard with install kits.

Pricing reflects the shelving unit and the bracket kits as a combined product.



Metris Products Now available!

- ▶ The Metris has arrived at your local dealerships.
- ▶ Ranger Design has a New Catalog available for you.
- ▶ Start training your dealer representative now.

[View Metris Catalog ▶](#)



Share your Ranger Story!

Do you have a story to share with us? A situation where a Ranger Safety Partition may have saved your life, or a circumstance where positive action was a direct result due to Ranger products.

We would enjoy hearing your story.
cs@rangerdesign.com

Take our Metris Training



Take our Metris sales training and receive your Free travel mug!

[Start Metris Training ▶](#)

New Wire Mesh Partition for the Metris

As of February 2016, we will be launching the C13-MM

The benefits of this new partition are:

- ▶ Low-cost
- ▶ Contoured
- ▶ Allows for full seat travel



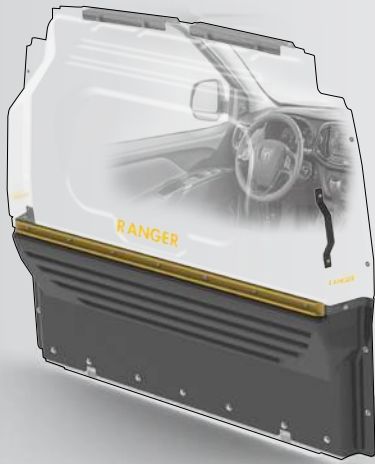

3320-PC MAX VIEW SHOWN

The Max View Partition series

As of March 2016, we are adding two new Max View Composite partitions to our new series joining the ProMaster City Max View composite partition 3320-PC:

- ▶ The Metris Max View composite partition # 3320-MM
- ▶ The Transit Connect Max View composite partition # 3320-TC

The benefits of this new series are

- ▶ Maximum visibility (180 degrees rear view)
- ▶ A tighter fit to the vehicle (helping maintain climate control)
- ▶ A greater sense of cabin space

These safety partitions are made up of thermoformed Polycarbonate and ABS.



Quick Ship Items

As of January 1st, 2016, the following products will be added to QuickShip:

- G210 Contractor Package Sprinter SWB Aluminum
- G211 Electrical/Telecom Pkg, Sprinter SWB
- G212 HVAC Pkg, Sprinter SWB Aluminum
- G215 Plumber Pkg, Sprinter SWB Aluminum
- G216 Service Pkg, Sprinter SWB Aluminum
- G219 Delivery Package, Sprinter SWB Aluminum
- G710 Contractor Package Sprinter LWB Aluminum
- G711 Electrical/Telecom Pkg, Sprinter LWB
- G712 HVAC Pkg, Sprinter LWB Aluminum
- G715 Plumber Pkg, Sprinter LWB Aluminum
- G716 Service Pkg, Sprinter LWB Aluminum
- G719 Delivery Package, Sprinter LWB Aluminum
- Z10-G2 Base Package, Sprinter SWB Steel

- Z10-G7 Base Package, Sprinter LWB Steel
- Z16-G2 Service Package, Sprinter SWB Steel
- Z16-G7 Service Package, Sprinter LWB Steel
- 7111 Locker, contoured, Sprinter
- 7211 Workbench
- 7948 Bin unit, 48"L, contoured, Sprinter
- 4184-4 Shelf unit, contoured, Sprinter
- 7731 Locking door kit
- 7108 Bookshelf
- 7124 Reel holder

The following packages and units will no longer be available on QuickShip:

- G015 Plumber Pkg, Sprinter SWB Aluminum
- G115 Plumber Pkg, Sprinter SWB Aluminum
- G615 Plumber Pkg, Sprinter LWB Aluminum
- G619 Delivery Pkg, Sprinter LWB Aluminum
- Z10-P Contractor Pkg, Sprinter
- Z10-R Contractor Pkg, Sprinter
- Z30-P Contractor Upgrade Pkg, Sprinter
- Z30-R Contractor Upgrade Pkg, Sprinter
- 3069-DH Swing Door Partition, Sprinter, Aluminum
- 3069-DL Swing Door Partition, Sprinter, Aluminum
- 4184-5 Shelf unit, contoured, Sprinter
- 4160-5 Shelf unit, contoured, Sprinter
- 7960 Bin unit, contoured, Sprinter

84-7101 Discontinued

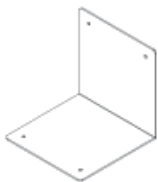

As of February 1st, 2016, the Wheelwell Mounting Plate for Fold-Away Shelving will be discontinued.

Sprinter Packages

- ▶ New Sprinter Packages will be shown in the 2016 Buyer's Guide as well as in the new Sprinter Catalog
- ▶ The main difference is that the safety partition is no longer included in the package

December Distributor Bulletin Did you miss it?



If you missed last month's Distributor Bulletin, click here to view and download.

[Download December Bulletin](#) ▶