

INSTALLATION GUIDE

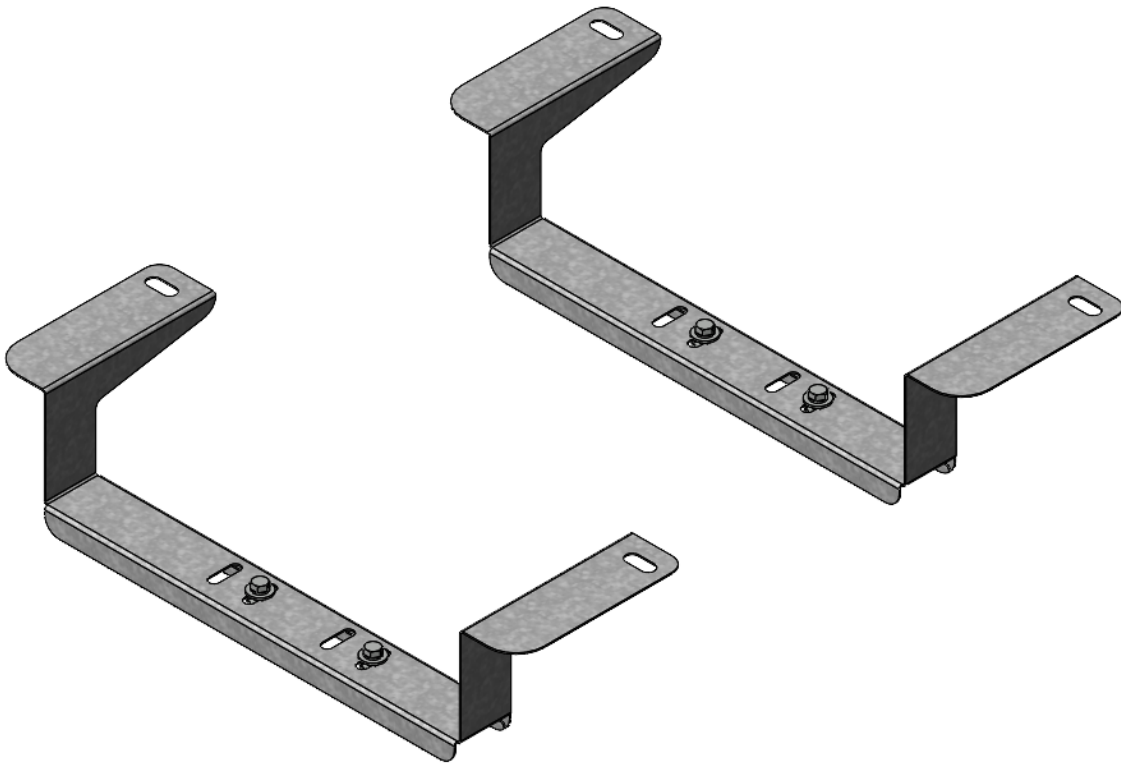

5041 Raised Base for 5040 Cab Box

Transit (Steel)



Scan the QR for the latest Install-Guide.





BEFORE YOU BEGIN

READ, UNDERSTAND, AND FOLLOW ALL WARNINGS AND INSTRUCTIONS BEFORE USING THIS PRODUCT. FAILURE TO FOLLOW THESE DIRECTIONS MAY RESULT IN PROPERTY DAMAGE, SERIOUS BODILY INJURY, AND/OR DEATH. RANGER DESIGN IS NOT RESPONSIBLE FOR ANY PROPERTY DAMAGE, PERSONAL INJURY, OR DEATH THAT OCCURRED WHILE USING ANY RANGER DESIGN PRODUCTS.



WARNING

- Failure to use Ranger Design-provided fasteners, brackets, and proper installation guidelines could increase risk of serious personal injury and/or death.
- If drilling is required to complete this installation: improper drilling can cause property damage to vehicles and could lead to electric shock, fire, or even death.
- If drilling is required to complete this installation: Ensure that drilling is only performed on areas of the vehicle allowed by the vehicle's Original Equipment Manufacturer's Body Builders Layout Book (or equivalent document).
- Prior to installation, inspect the vehicle to ensure that installation will not interfere with, or cause obstruction of, any critical components such as electrical wiring, fuel tanks, fuel-cells, locks, latches, etc.
- The installer or manufacturer is responsible for ensuring anchorages are installed onto suitable wall and floor structures; wall and floor strength must meet applicable performance requirements.
- Do not install systems into any weak or unsound materials such as plastics, woods, thin-walled metals, etc. without proper reinforcement.
- Do not install this product where it could interfere with the deployment of airbags. Failure to comply could result in death or serious injury.
- Do not install this product where it could ingress on the Transit Occupant Protection Zone. Failure to comply could result in death or serious injury.
- Incorrect installation could cause water leaks, electric shock or fire.
- Any cargo vehicle with any cargo or equipment should use a certified partition. See Ranger Design website for some partition options. (<https://rangerdesign.com/>)
- Mountings rails are recommended for any attachment to the vehicle walls.
- All items in the cargo area should be properly secured and partition doors closed while the vehicle is in motion.
- Check your vehicle's tare weight and remaining load capacity with all the equipment installed. Never exceed the maximum Gross Vehicle Weight Rating (GVWR), Gross Axle Weight Ratings (GAWRs), or other maximum loads permitted by the vehicle's Original Equipment Manufacturer (OEM) and required by law.
- The heaviest items must be placed towards the bottom of the vehicle, while the lightest ones can be arranged upwards. Vehicle cargo loading weight proportion should follow the following guidelines:

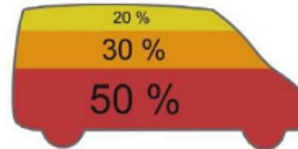

- The final alterer and/ or modifier should review the warning sheet with the customer before the vehicle is released to the customer or for general use. These instructions should remain with the vehicles a all times.
- Any modification or unintended use of this product voids any warranty and could create a hazardous condition.
- Ranger Design provides recommended assembly and installation instructions which should be followed to ensure correct operation. Failure to do so could result in invalidating the product's compliance, warranty and cause injury. Notwithstanding, the final stage vehicle alterer and/or modifier is responsible for the integration, installation, and compliance of the product in its final location to all applicable regulations and standards. Failure to maintain compliance of the vehicle to applicable regulations and standards could be punishable by law. Alterers and/or modifiers should consult with all local authorities prior to commissioning.



CAUTION

- Drilling is required to complete this installation. Before drilling, ensure that you will not hit any critical parts of the vehicle like the gas tank, wiring harness, or hose. Consult the vehicle OEM documentation as necessary. When drilling, use a drill collar to reduce the risk of damage to the vehicle.
- Any materials, padding, or glazing installed in the vehicle must comply with FMVSS/CMVSS 201/205/302, as applicable.
- In the event of a motor vehicle accident or collision where a Ranger system has been installed, especially ones where the vehicle structure is damaged and/or the air bags deploy and/or the vehicle has been towed, the system must be inspected to ensure continued soundness and safety before returning the vehicle to service. Damaged components should be replaced as necessary.
- All system components should be regularly inspected, cleaned, and maintained pursuant to Ranger guidelines.

QUICK START GUIDE

Phase 1 - Assembly

❑ 1.1 Setup.....	4
------------------	---

Phase 2 - Installation

❑ 2.1 Installation.....	6
❑ 2.2 Install With 5040 Cab Box.....	7

REQUIRED ITEMS

- ❑ Cordless Impact
- ❑ Ratchet
- ❑ T40 Torx Bit



1
PERSON

PHASE 1 – ASSEMBLY

1.1 SETUP

1.1.1 Unpack all the components and compare with the bill of materials.

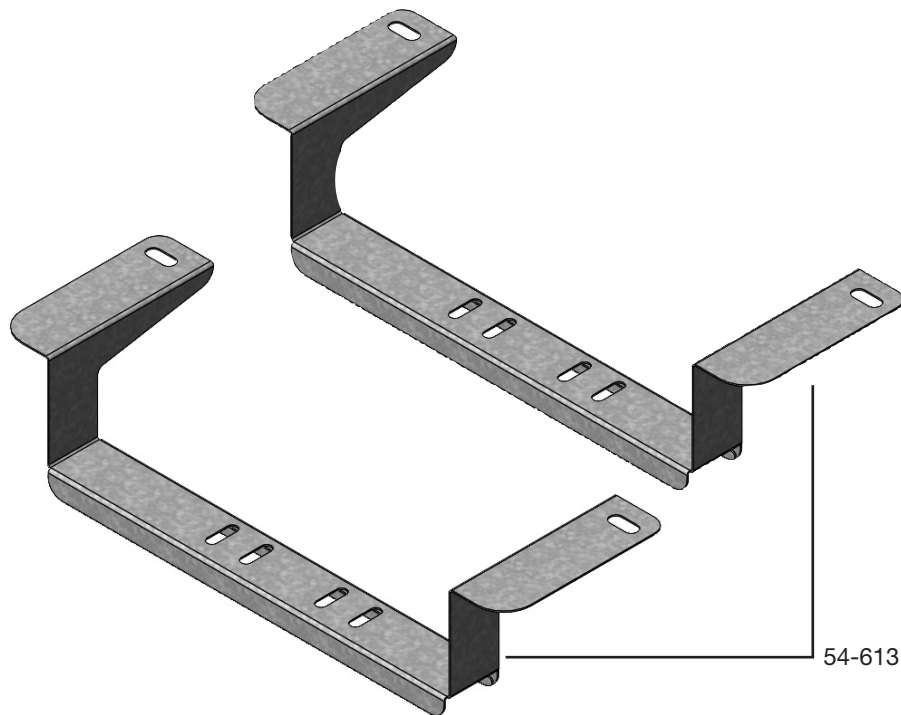

1.1.2 Verify all parts are present.

BILL OF MATERIALS

Item No.	Description	Qty.
54-613	Transit 2020, Cab Box Support, Front	2
94-5005	Assembly Fastener Kit	1

1.1.3 Fastener kits.



94-5005 Fastener Kit



Fastener Assembly

4x		# 90-110	Hex Bolt 1/4"-20x 3/4" GR-5 ZINC
4x		# 94-201	Nut, Clip-On 1/4"-20
4x		# 98-112	Flat Washer 1/4" ZINC
4x		# 98-118	Lock Washer Regular 1/4" ZINC

4x

	#90-110 Hex Bolt 1/4"x3/4"
	#98-118 Lock Washer
	#98-112 Flat Washer
	#94-201 Nut, Clip-On

PHASE 2 – INSTALLATION

2.1 INSTALLATION

- 2.1.1** • To mount both cab box brackets, both front seats need to be loosened from their base.
• On each seat, remove the 2 inner Torx bolts and loosen the 2 outer Torx bolts.

NOTE: Move the seats forward and rearward to gain access to the bolts.

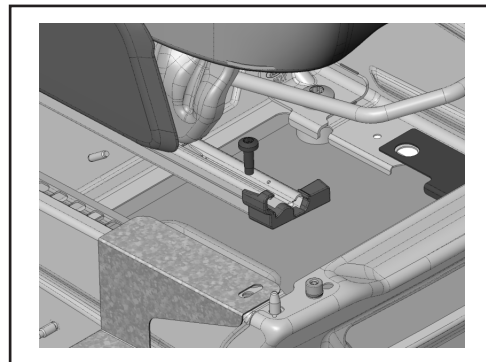
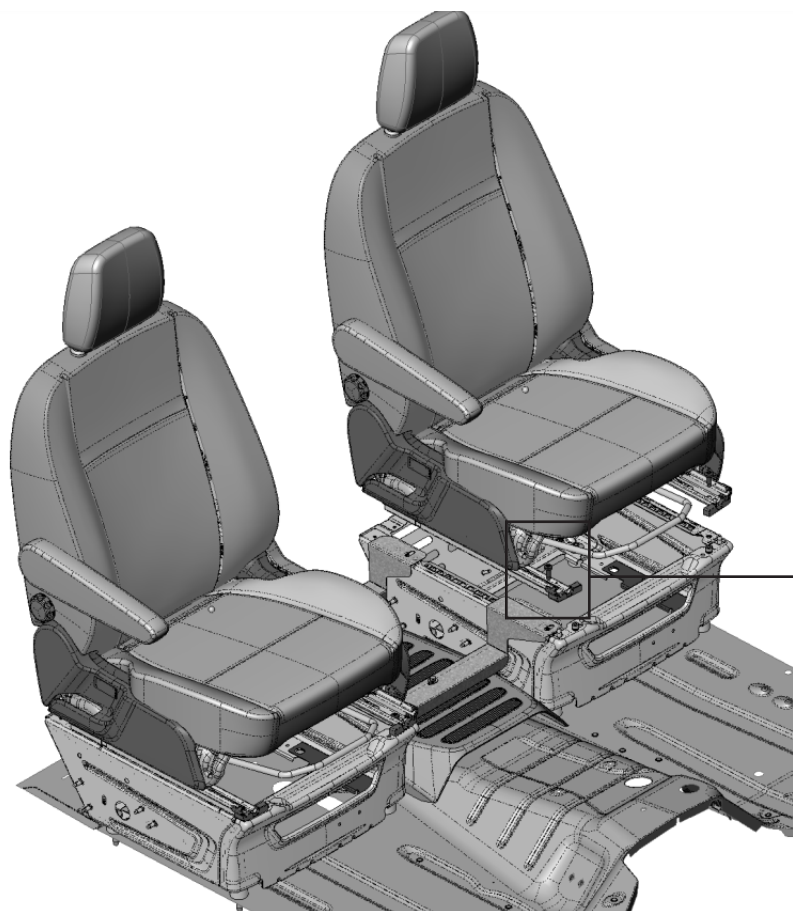

TOOLS

- T40 Torx bit

PHASE 2 – INSTALLATION

2.1 INSTALLATION

- 2.1.2**
- Place the cab box brackets over the seat bases. Take note of the orientation.
 - Replace the seats.
 - Install the Torx bolts using the recommended factory torque setting.

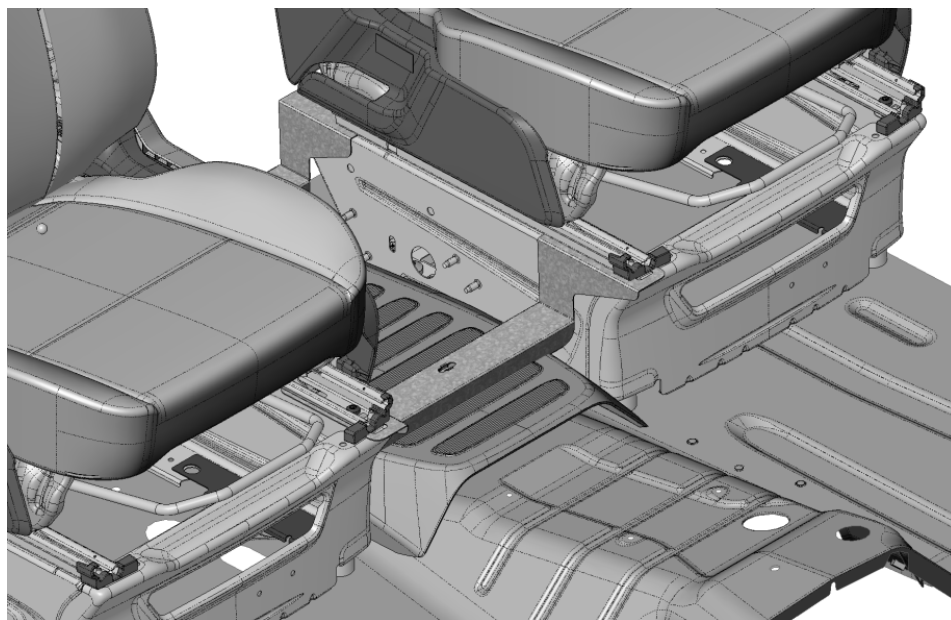
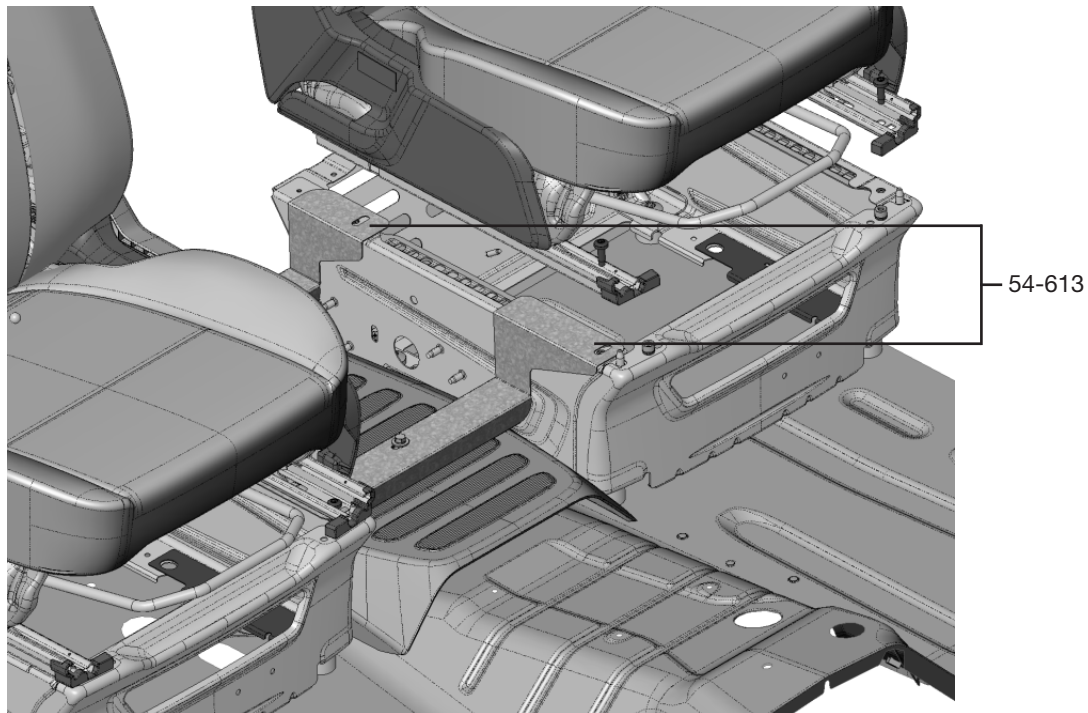

TOOLS
□ T40 Torx bit

PHASE 2 – INSTALLATION

2.2 INSTALL WITH 5040 CAB BOX

2.2.1 • Install the Clip-On Nuts on the underside of both cab box brackets.

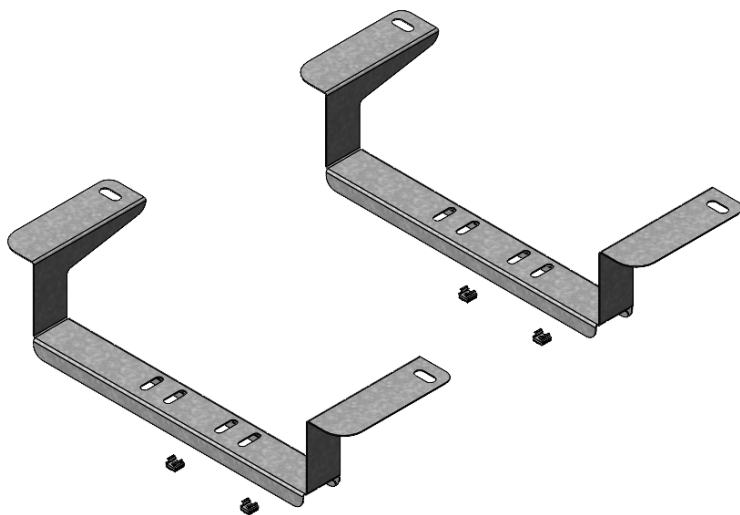

NOTE:

If there is a hand brake, use the side slots on both box supports.

If there is no hand brake, use the center slots on both box supports.

HARDWARE USED

4x



#94-201 Nut, Clip-On

2.2.2 • Place and attach the 5040 Cab Box on the brackets.

NOTE: 5040 Cab Box is a separate unit.

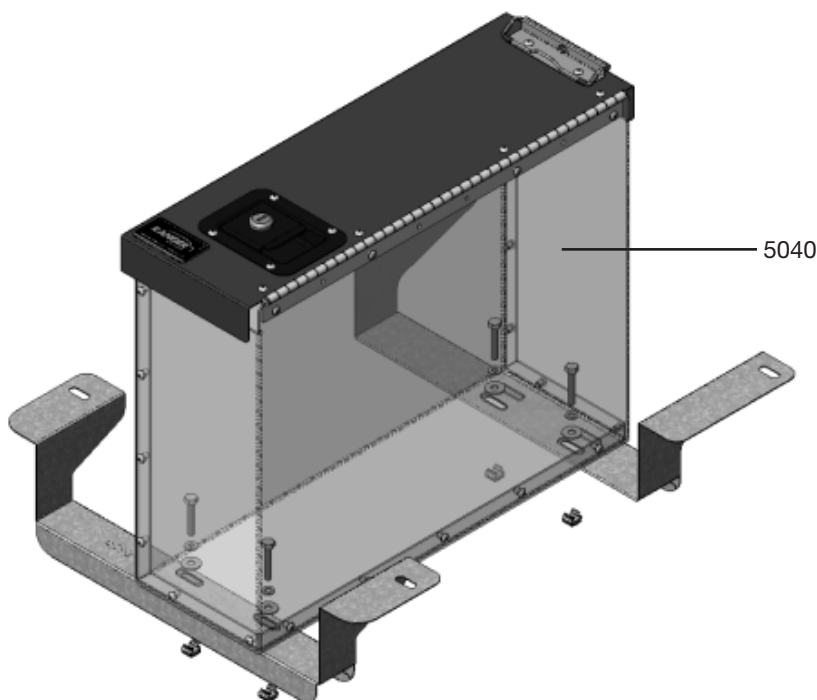

TOOLS

- ☐ Cordless Impact
- ☐ 7/16" Driver Bit

HARDWARE USED

4x



#90-110 Hex Bolt 1/4" x 3/4"



#98-118 Lock Washer



#98-112 Flat Washer



#94-201 Nut, Clip-On

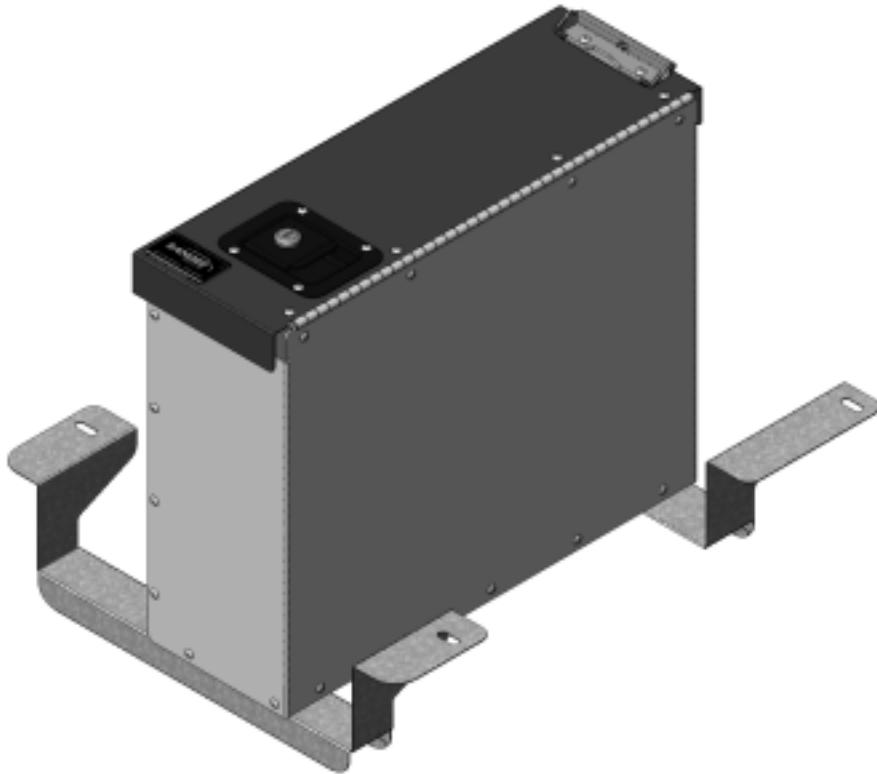

**You have successfully installed your
5041 Raised Base.**

**Thank you for doing business with us.
Ranger Design**

For any feedback or suggestions you may have, please contact: cs@rangerdesign.com

