

INSTALLATION GUIDE



1530-NL Double Clamp Ladder Rack

Nissan NV 140" Wheelbase Low Roof (Aluminum)



QUICK START GUIDE

Phase 1 - Assembly

❑ 1.1 Setup.....	3 - 5
❑ 1.2 Ladder Rack Assembly.....	5 - 15

Phase 2 - Installation

❑ 2.1 Mounting Tracks Installation.....	16
❑ 2.2 Ladder Rack Installation.....	17 - 20
❑ 2.3 Note.....	21

REQUIRED ITEMS

NOTE: Use Sawhorses if possible, or use the box as a flat protective surface on the ground or table.

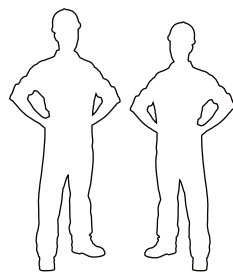

**2
PERSONS**

- ❑ Cordless Impact
- ❑ Ratchet
- ❑ Tape Measure
- ❑ Mallet
- ❑ Marker
- ❑ Ladder
- ❑ Cutter
- ❑ 1/2" Socket
- ❑ Sawhorse (Optional)
- ❑ Box
- ❑ Knife
- ❑ 1/2" Wrench

PHASE 1 – ASSEMBLY

1.1 SETUP

1.1.1 Unpack components; compare with the bill of materials.

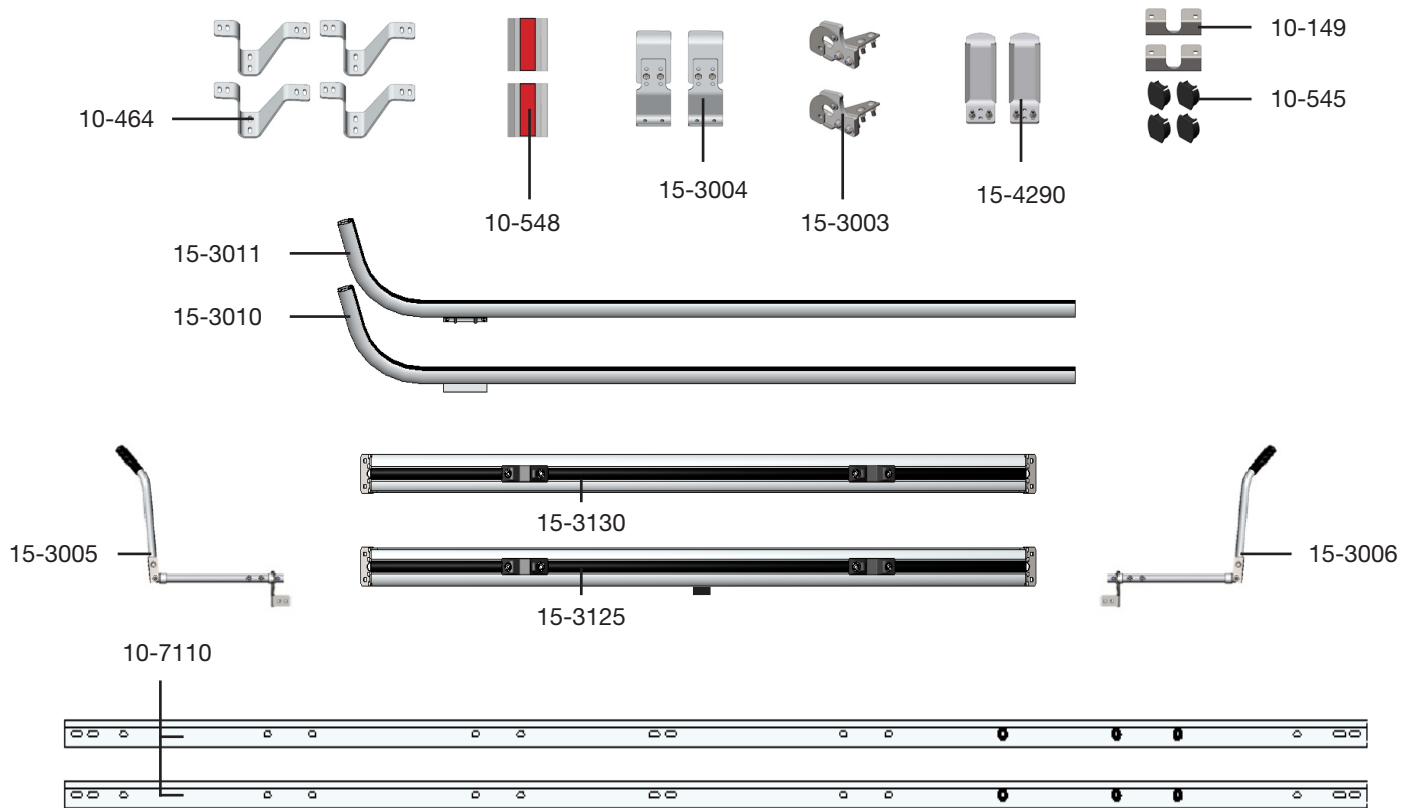

1.1.2 Verify all parts are present.

BILL OF MATERIALS

Item No.	Description	Qty.
10-149	Clamp Handle Support	2
10-464	"V" Foot	4
10-545	Ski Plastic Plug	4
10-548	Hook Protector (4 - 3/8" L)	2
10-7110	Mounting Track	2
15-3003	Ladder Clamp Hasp	2
15-3004	Ladder Clamp Rear Hook	2
15-3005	Ladder Clamp Bar (Driver Side)	1
15-3006	Ladder Clamp Bar (Passenger Side)	1
15-3010	Ski (Left)	1
15-3011	Ski (Right)	1
15-3125	Rear Crossbow	1
15-3130	Front Crossbow	1
15-4290	Front Hook	2
94-1012	Assembly Fastener Kit	1
96-1011	Install Fastener Kit	1

1.1.3 Fastener kits.

94-1012 Fastener Kit

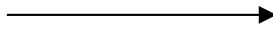

Fastener Assembly

4x



90-487

Carriage Bolt
5/16"-18 x 3/4"
SS304

22x



90-491

Carriage Bolt
5/16"-18 x 1"
SS304

30x



94-105

Hex Nut
5/16"-18
SS316wax

2x



98-160

Spacer
SS18-8

30x



98-117

Flat Washer
5/16", O.D 3/4"
SS18-8

30x



98-123

Lock Washer
Regular 5/16"
SS304

4x



#90-487 Carriage Bolt 5/16" x 3/4"



#98-117 Flat Washer



#98-123 Lock Washer



#94-105 Hex Nut

20x



#90-491 Carriage Bolt 5/16" x 1"



#98-117 Flat Washer



#98-123 Lock Washer



#94-105 Hex Nut

4x



#98-117 Flat Washer



#98-123 Lock Washer



#94-105 Hex Nut

2x



#90-491 Carriage Bolt 5/16" x 1"



#98-160 Spacer



#98-117 Flat Washer



#98-123 Lock Washer



#94-105 Hex Nut

96-1011 Fastener Kit

Fastener Assembly

20x		# 90-203	Hex Bolt 5/16"-18 x 5/8" SS304
8x		# 90-209	Hex Bolt 5/16"-18 x 1" SS304
28x		# 94-150	Channel Nut 5/16"
28x		# 98-117	Flat Washer 5/16", OD 3/4" SS18-8
28x		# 98-123	Lock Washer 5/16" SS304

20x

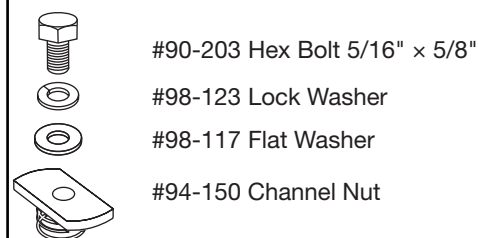

8x

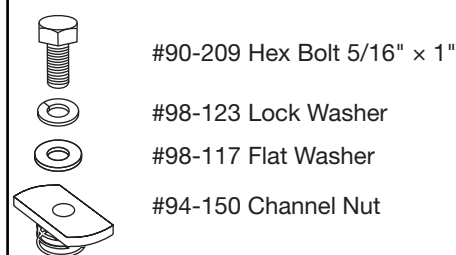

PHASE 1 – ASSEMBLY

1.2 LADDER RACK ASSEMBLY

1.2.1 Peel the backer off of the adhesive on the hook protector, then attach the hook protector to the upper rear hook.

2x

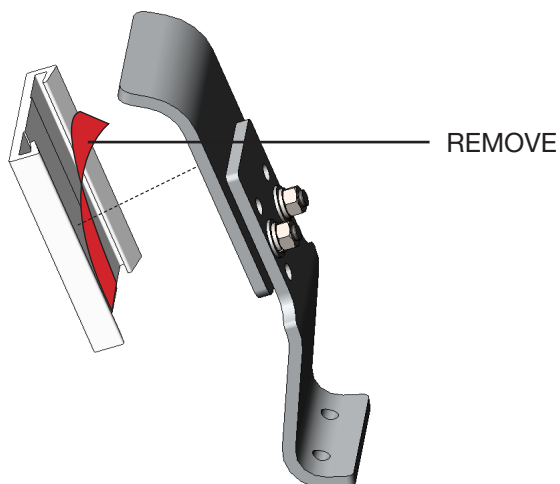

TOOLS

□ Knife

1.2.2 Attach the rear hooks to the ladder clamps, with the pre-assembled hardware on the pivot bars.

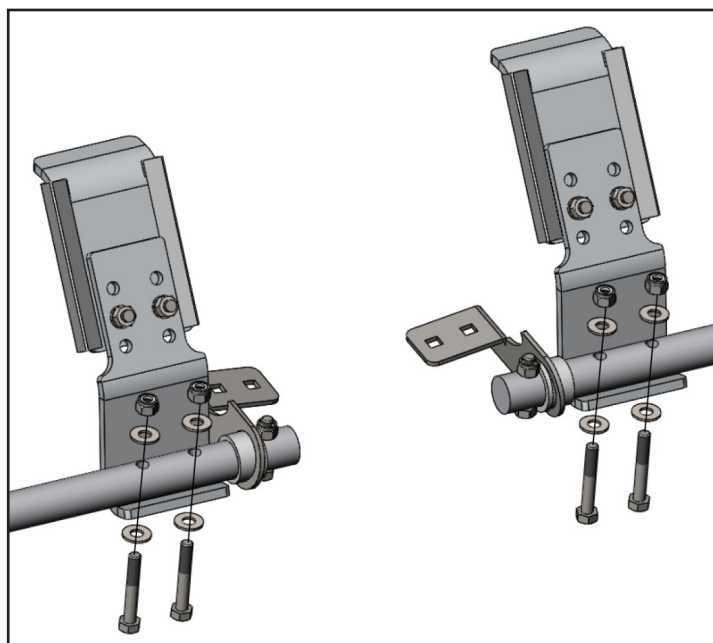
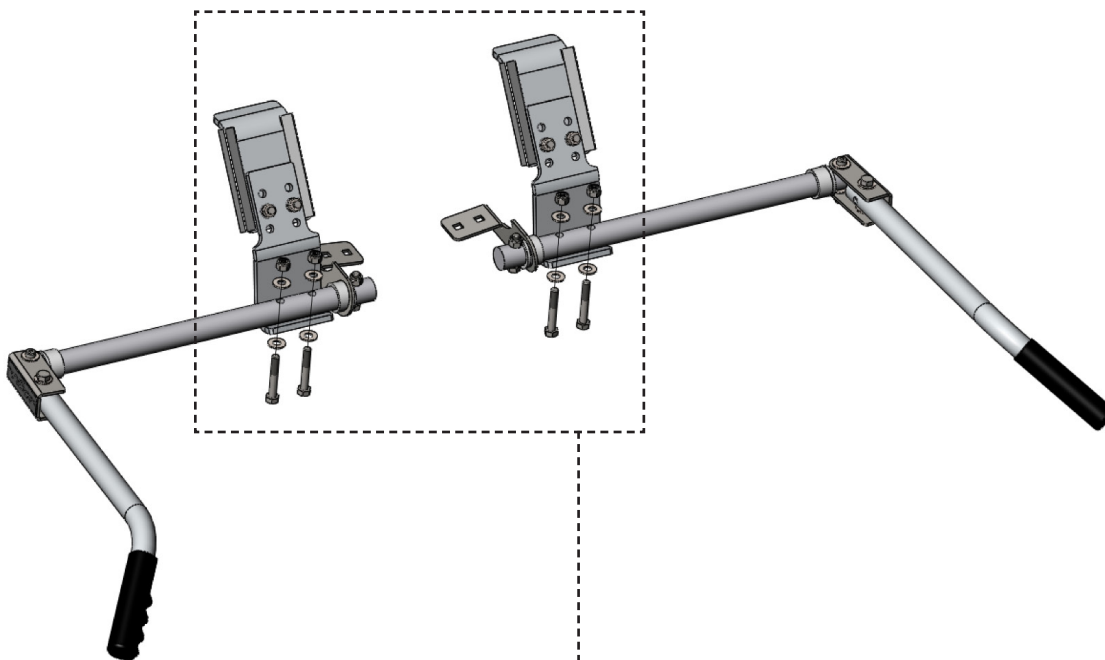

TOOLS

- Cordless Impact
- 1/2" Socket
- 1/2" Wrench

HARDWARE USED

4x HARDWARE IS PRE-ASSEMBLED.

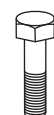

#90-225 Hex Bolt
5/16" - 18 x 2" SS304



#98-117 Flat Washer



#98-117 Flat Washer



#94-111 Lock Nut

1.2.3 Slide carriage bolts on the bottom face of the crossbows.

NOTE: The track plug must be removed from the underneath of the crossbows, and reinstalled after the feet have been installed in the final position.

TIPS: Use tape to keep the bolts from sliding off.



DRIVER SIDE

Front crossbow

- Slide 4 pcs. of 1" carriage bolts.

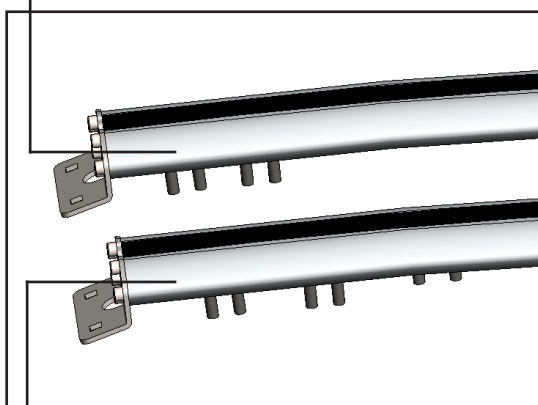

Rear crossbow

- Slide 2 pcs. of 3/4" carriage bolts.
- Slide 4 pcs. of 1" carriage bolts.

HARDWARE USED

2x



#90-487 Carriage Bolt
5/16" x 3/4" SS304

8x



#90-491 Hex Bolt
5/16" x 1" SS304

PASSENGER SIDE

Front crossbow

- Slide 4 pcs. of 1" carriage bolts.

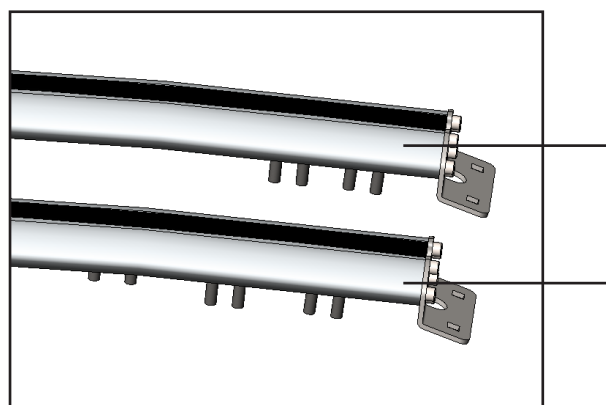

Rear crossbow

- Slide 2 pcs. of 3/4" carriage bolts.
- Slide 4 pcs. of 1" carriage bolts.

HARDWARE USED

2x



#90-487 Carriage Bolt
5/16" x 3/4" SS304

8x



#90-491 Hex Bolt
5/16" x 1" SS304

1.2.4 Install the feet on the front, and rear crossbows.

NOTE: The more slanted side of the V foot should be closer to the center of the crossbow.

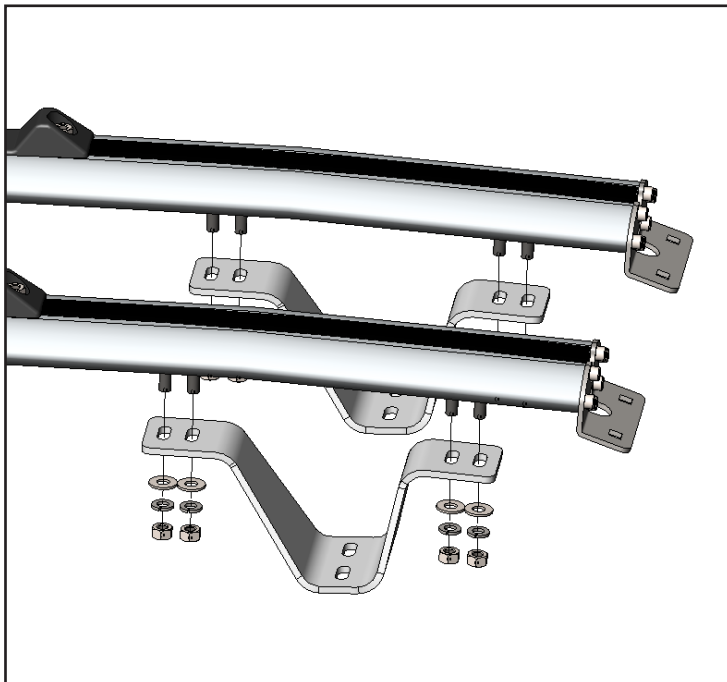
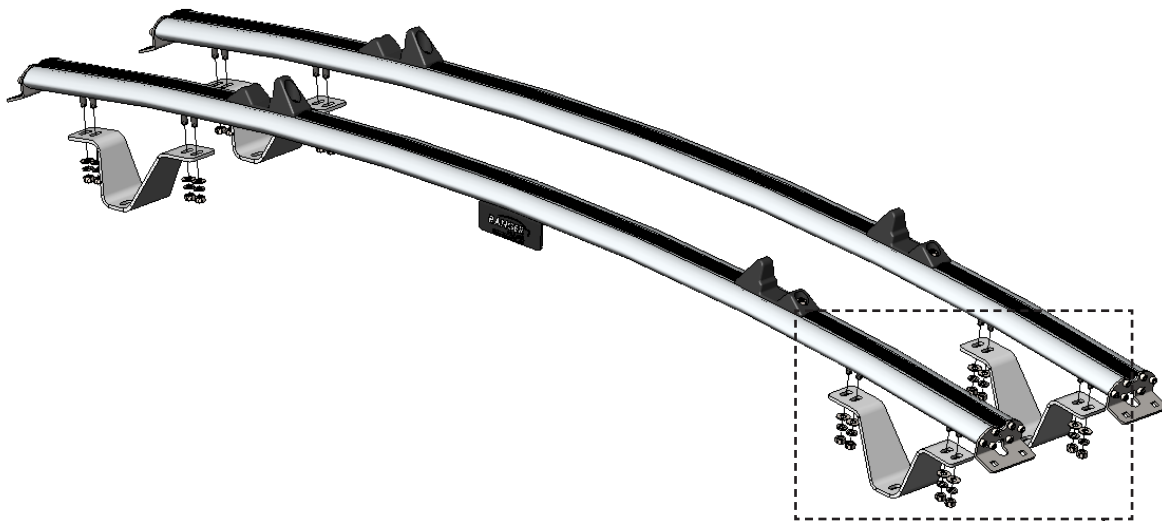

HARDWARE USED

16x HAND-TIGHTEN THE NUTS.



Carriage bolts are already on the crossbows.



#98-117 Flat Washer



#98-123 Lock Washer



#94-105 Hex Nut

1.2.5 Fasten the ladder clamp assemblies to the rear crossbow.

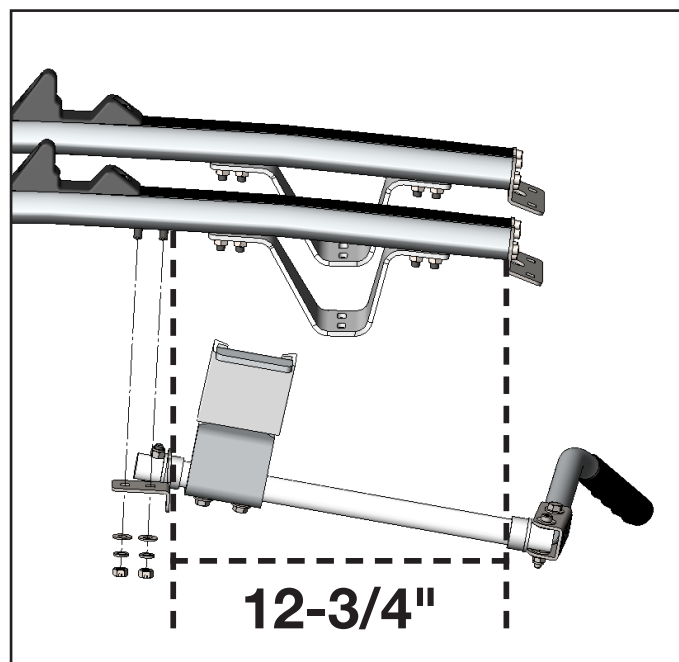
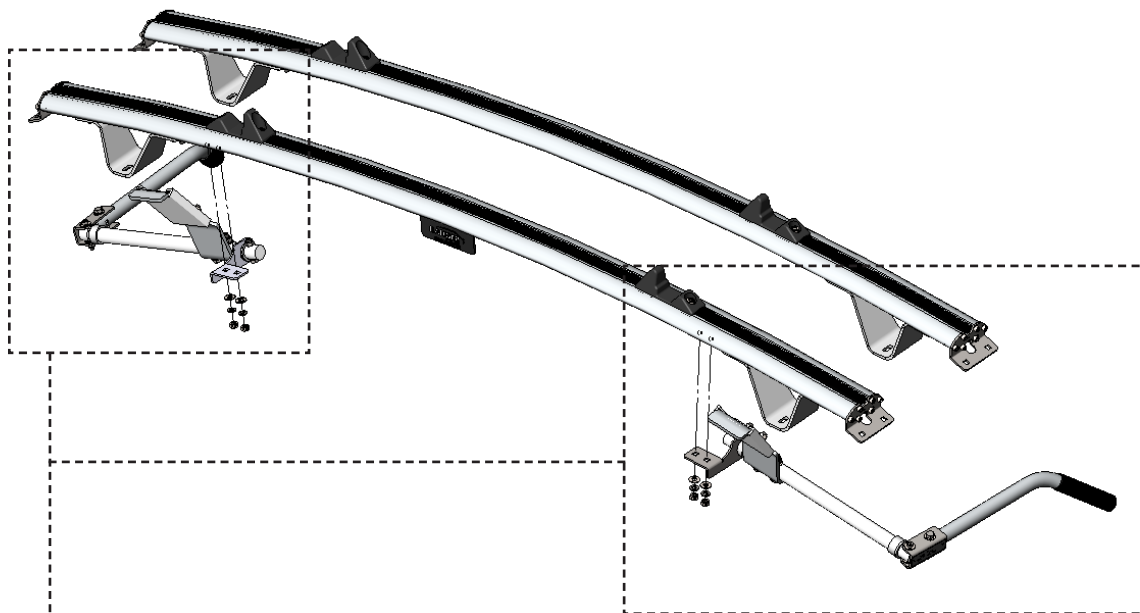

TOOLS

- ☐ Cordless Impact
- ☐ 1/2" Socket
- ☐ Tape Measure
- ☐ Marker

HARDWARE USED

4x



Carriage bolts are already on the crossbows.



#98-117 Flat Washer



#98-123 Lock Washer



#94-105 Hex Nut

- 1.2.6**
- Pull out the 14.5" track plug on both ends of the front crossbow.
 - Loosen the pre-assembled hardware on the front hooks and slide the hooks onto the front crossbow to the position shown below.
 - Cut the track plug, then attach it back to the crossbow.

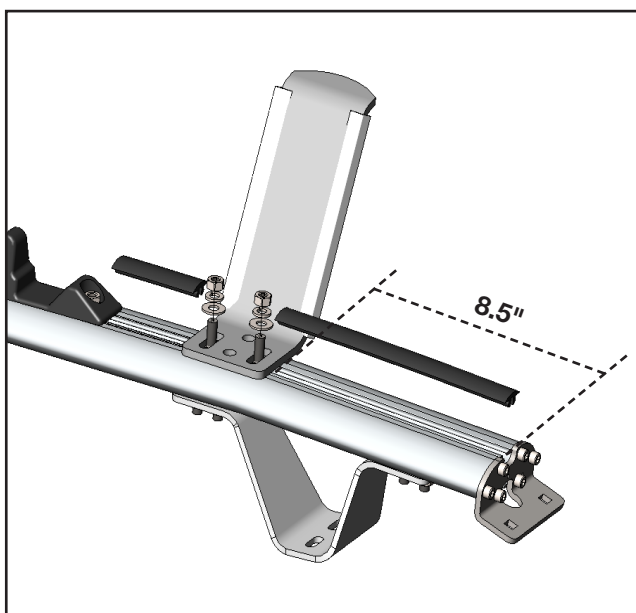
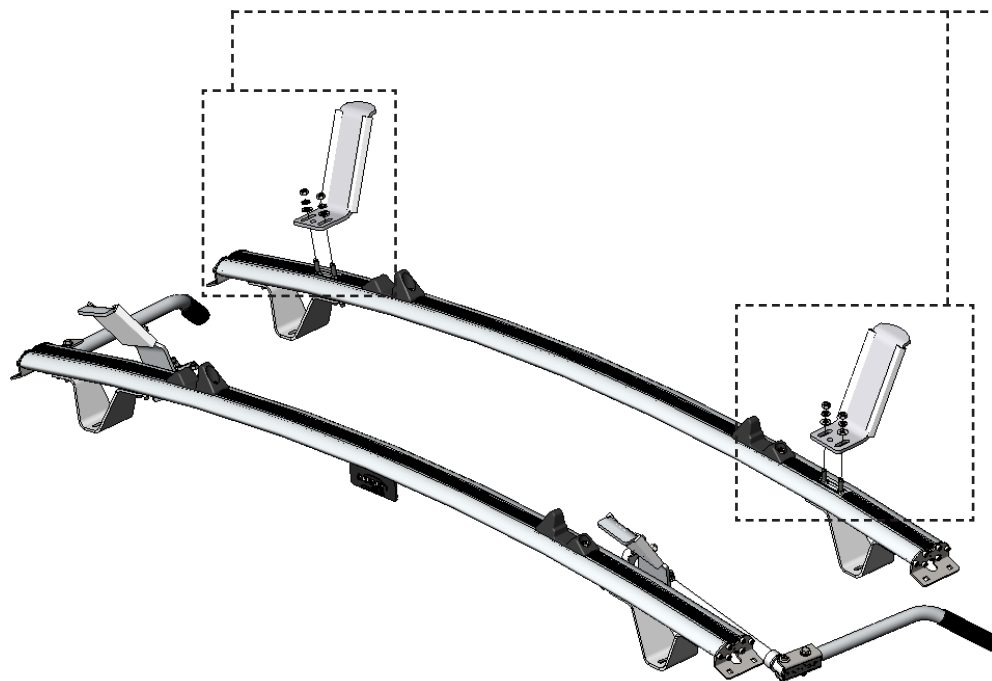

Tighten the nuts just to hold the front hook for adjustment.

TOOLS

- ☐ Marker
- ☐ Cutter

HARDWARE USED

4x HARDWARE IS PRE-ASSEMBLED.



#90-491 Carriage Bolt 5/16" x 1"



#98-117 Flat Washer



#98-123 Lock Washer



#94-105 Hex Nut

1.2.7 Install the left and right Skis to the end brackets of the front crossbow.

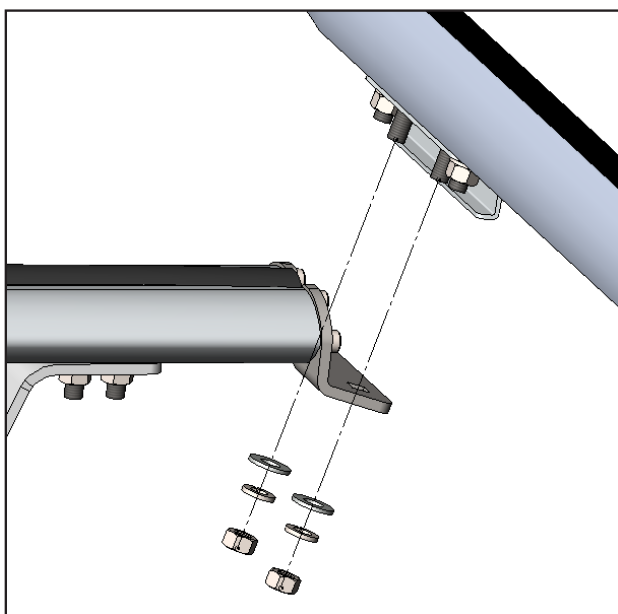
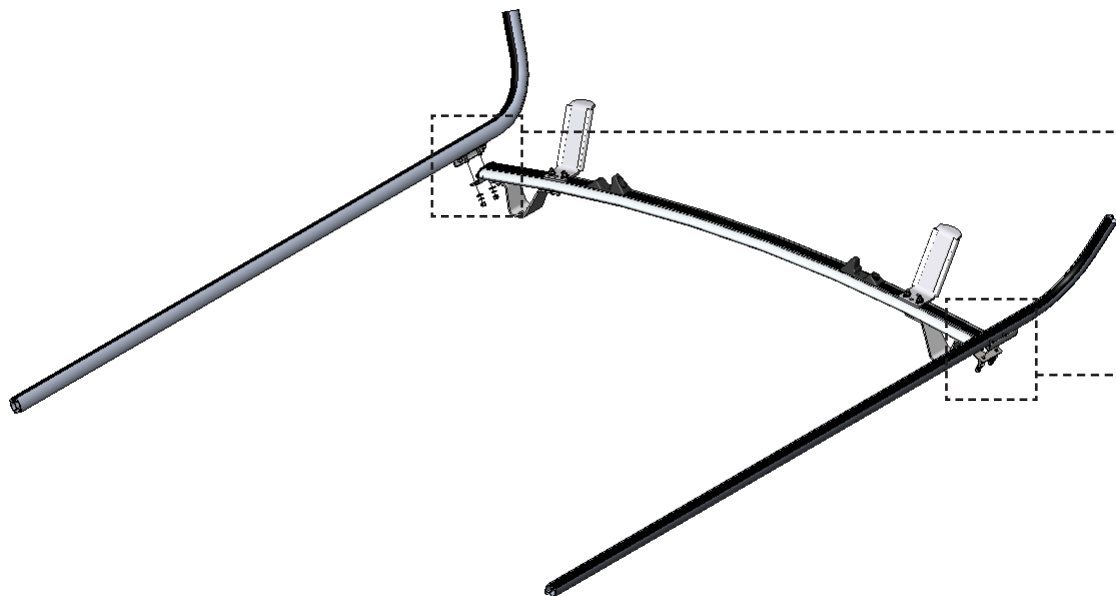





TOOLS

- Cordless Impact
- 1/2" Socket

HARDWARE USED

4x

-  Carriage bolts are already on the ski.
-  #98-117 Flat Washer
-  #98-123 Lock Washer
-  #94-105 Hex Nut

NOTE: If you have a third crossbow, stop here and open the third crossbow box and follow the installation guide to assemble the third crossbow.

1.2.8 After assembling the third crossbow attach the third crossbow to the skis.



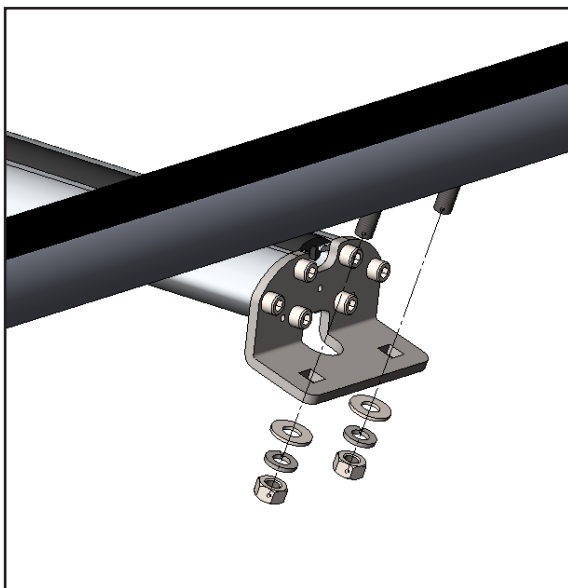
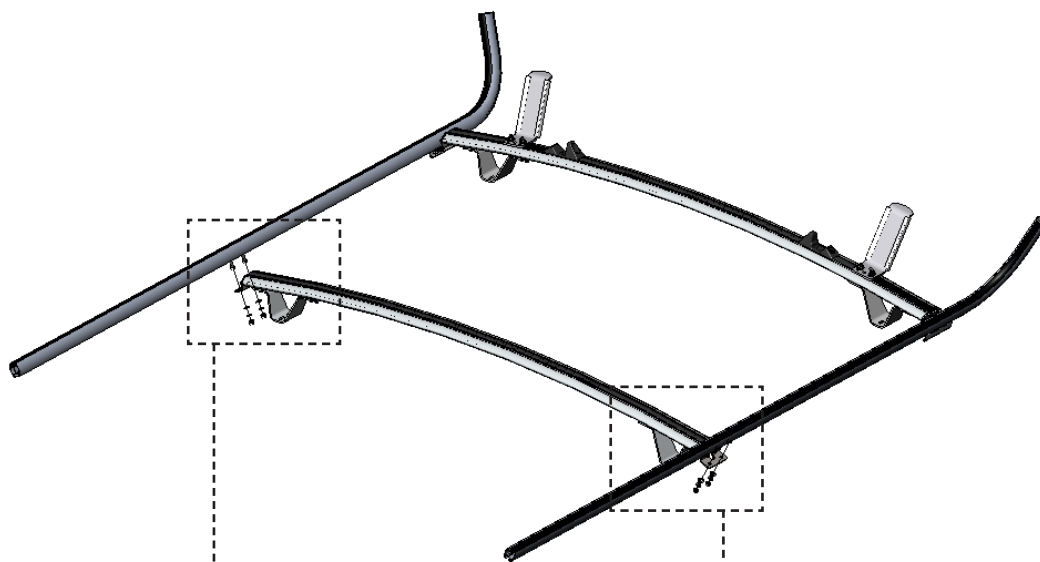

NOTE: Don't do this step if you don't have the third crossbow.



Use the assembly fastener kit of the third crossbow.

HARDWARE USED

4x HAND-TIGHTEN THE NUTS.

- | | |
|---|----------------------------------|
|  | #90-491 Carriage Bolt 5/16" x 1" |
|  | #98-117 Flat Washer |
|  | #98-123 Lock Washer |
|  | #94-105 Hex Nut |

1.2.9 Loosen the pre-assembled hardware on the ladder clamp hasps, slide the hasps on the ski to the position shown below, and tighten the nuts.

THIRD CROSSBOW

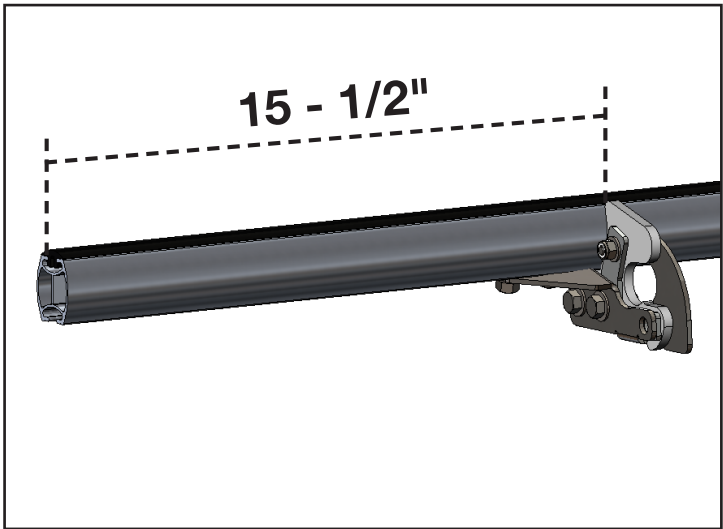
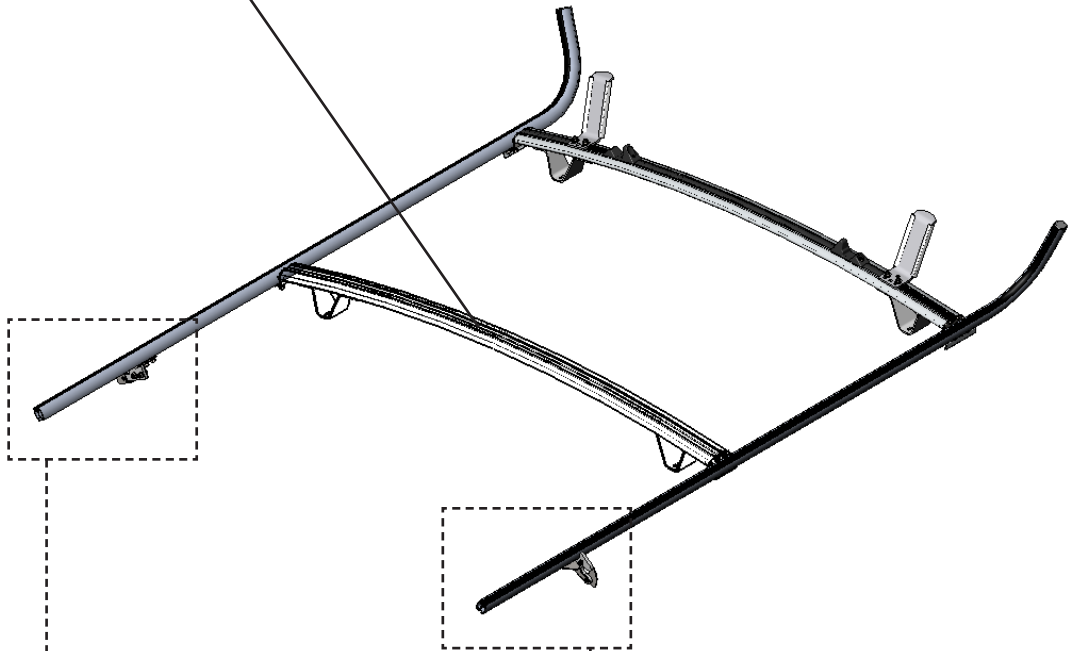

TOOLS

- ☐ Cordless Impact
- ☐ 1/2" Socket
- ☐ Tape Measure
- ☐ Marker

HARDWARE USED

4x HARDWARE IS PRE-ASSEMBLED.



#90-487 Carriage Bolt 5/16" x 3/4"



#98-117 Flat Washer



#98-123 Lock Washer



#94-105 Hex Nut

1.2.10 Slide 3pcs. of carriage bolts on the rear end of the each ski, then attach end plugs on both ends of the skis.

THIRD CROSSBOW

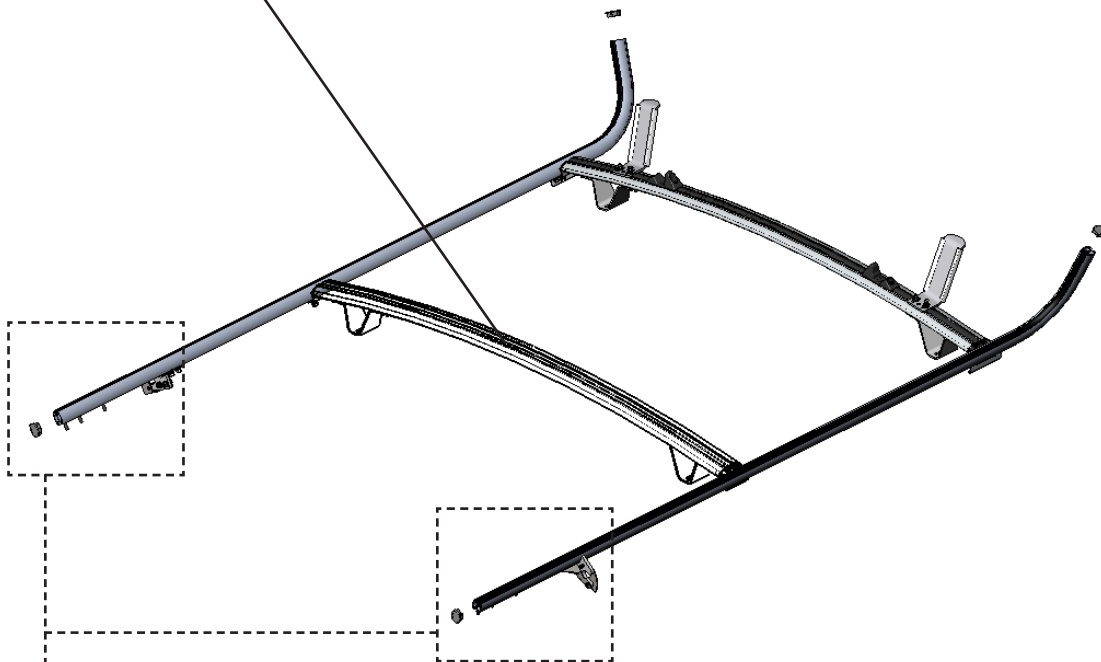

END PLUG



TOOLS

□ Mallet

HARDWARE USED

6x



#90-491 Carriage Bolt
5/16" x 1" SS304

1.2.11 Install the Rear Crossbow to the skis with the clamp handle supports, aligning the rear surface of the crossbow brackets to the rear surface of the skis.

THIRD CROSSBOW

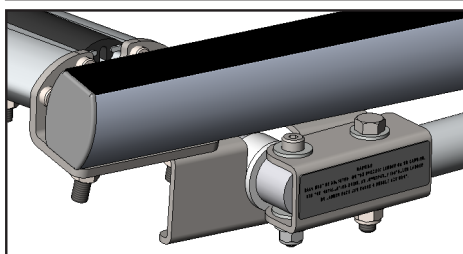
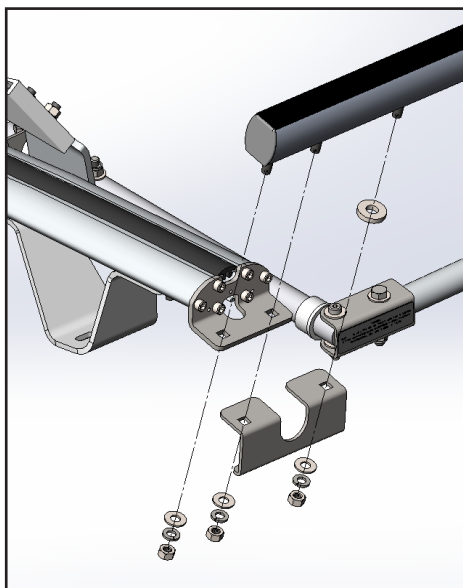
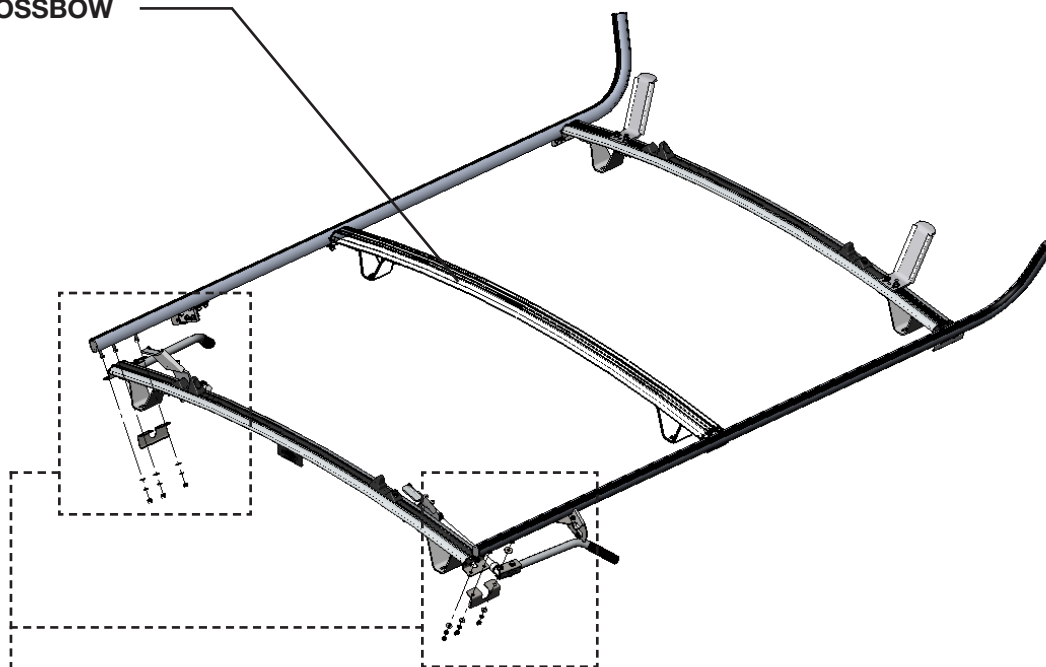

TOOLS

- Cordless Impact
- 1/2" Socket

HARDWARE USED

4x



Carriage bolts are already on the ski.



#98-117 Flat Washer



#98-123 Lock Washer



#94-105 Hex Nut

2x



Carriage bolts are already on the ski.



#98-160 Spacer



#98-117 Flat Washer



#98-123 Lock Washer



#94-105 Hex Nut

PHASE 2 – INSTALLATION

2.1 MOUNTING TRACKS INSTALLATION

2.1.1 Install the channel nuts in the roof.

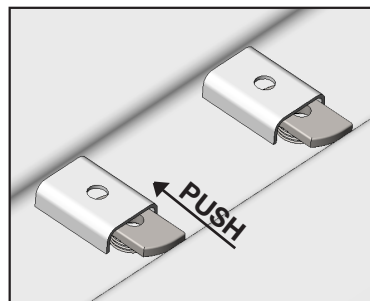
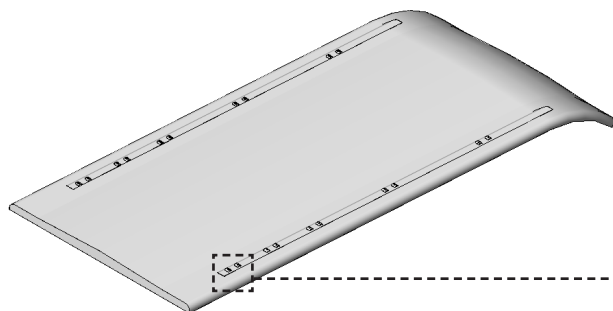

FASTENERS USED

20x

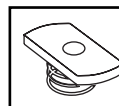

#94-150 Channel Nut

2.1.2 Install the mounting tracks onto the roof of the van by aligning the holes to the channel nuts.

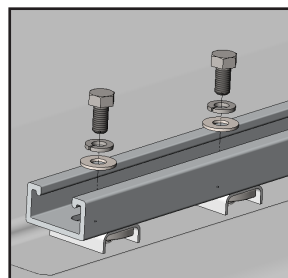
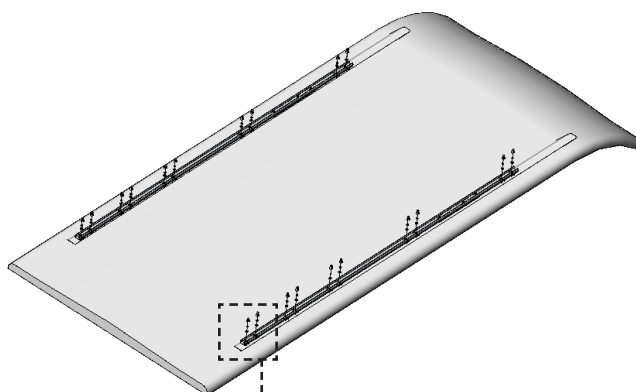

TOOLS

- ☐ Cordless Impact
- ☐ 1/2" Socket

FASTENERS USED

20x



#90-203 Hex Bolt 5/16" x 5/8"



#98-123 Lock Washer



#98-117 Flat Washer



Channel Nuts are already on the van.

PHASE 2 – INSTALLATION

2.2 LADDER RACK INSTALLATION

2.2.1 Position the Ladder Rack (**minimum two persons**) on the vehicle so that the feet are on the tracks.

NOTE: If you do not have a hoist, lift the ladder rack onto the roof manually.

Ladder Rack

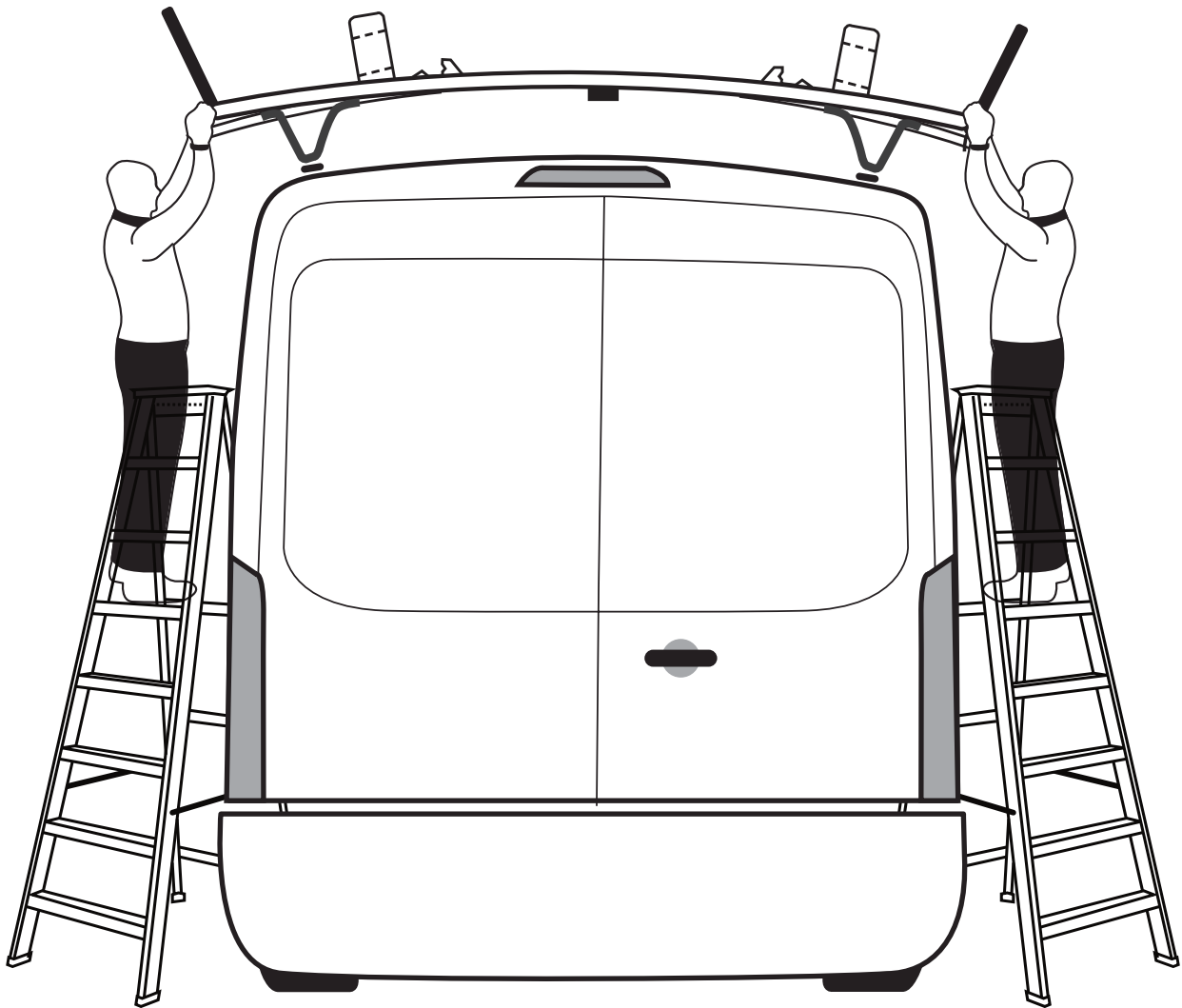

2.2.2 While making sure the crossbows are parallel to each other, slide the rack to the appropriate position, then attach all the “V” feet to the mounting tracks.

NOTE:

- If you have a third crossbow, center the third crossbow between the front and rear crossbows.
- Use the third crossbow install faster kit for the third crossbow feet installation.

THIRD CROSSBOW

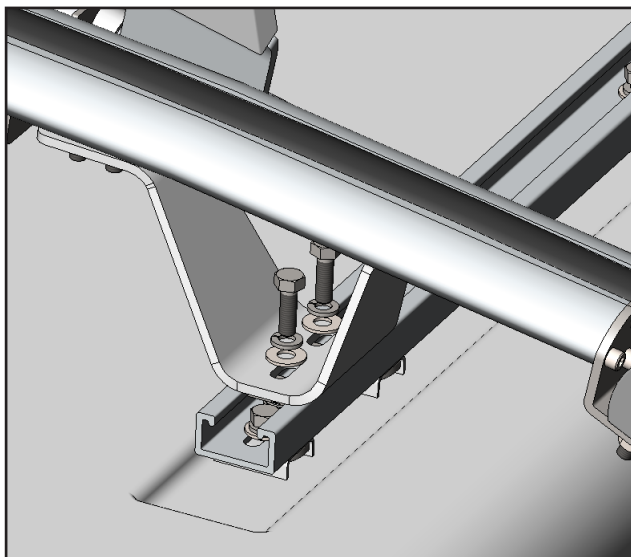
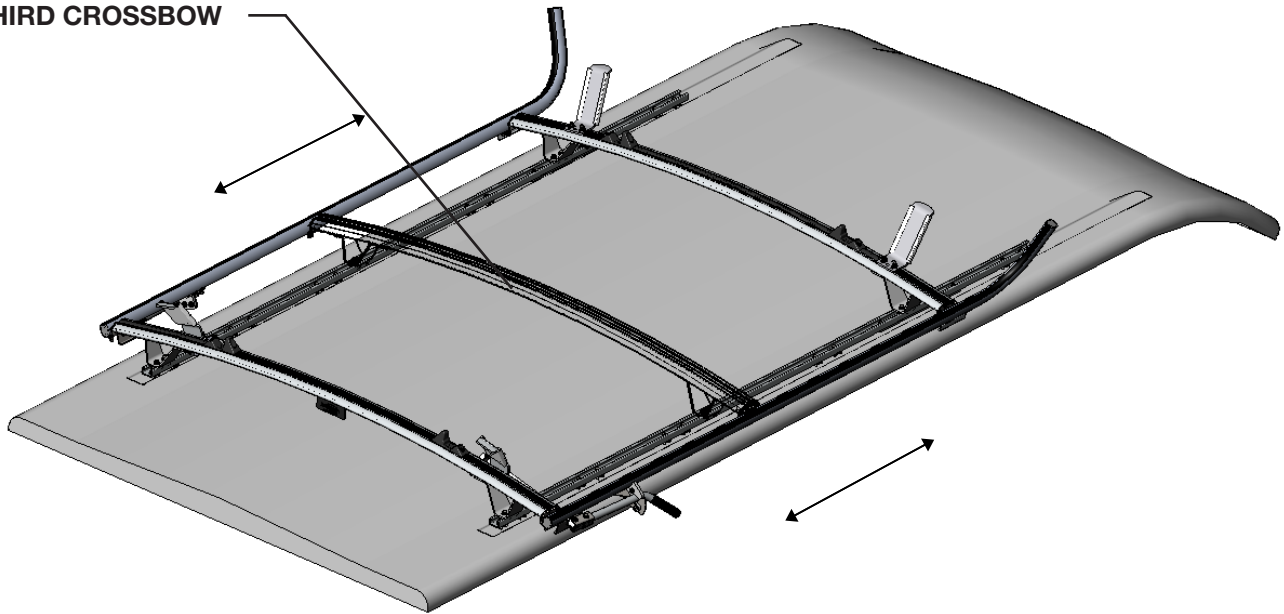

TOOLS

- ☐ Ratchet
- ☐ 1/2" Socket
- ☐ Tape Measure

FASTENERS USED

8x

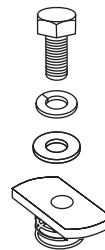

#90-209 Hex Bolt 5/16" x 1"

#98-123 Lock Washer

#98-117 Flat Washer

#94-150 Channel Nut

2.2.3 Center the crossbows on the vehicle, then tighten all the “V” feet to the crossbows.

NOTE: If you have a third crossbow, center the third crossbow between the front and rear crossbows.

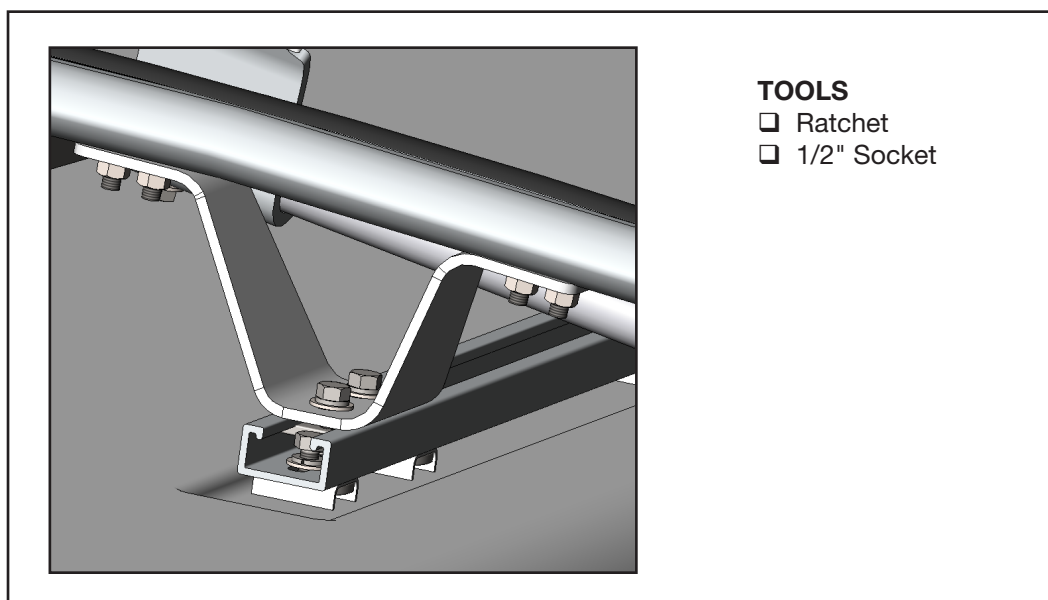
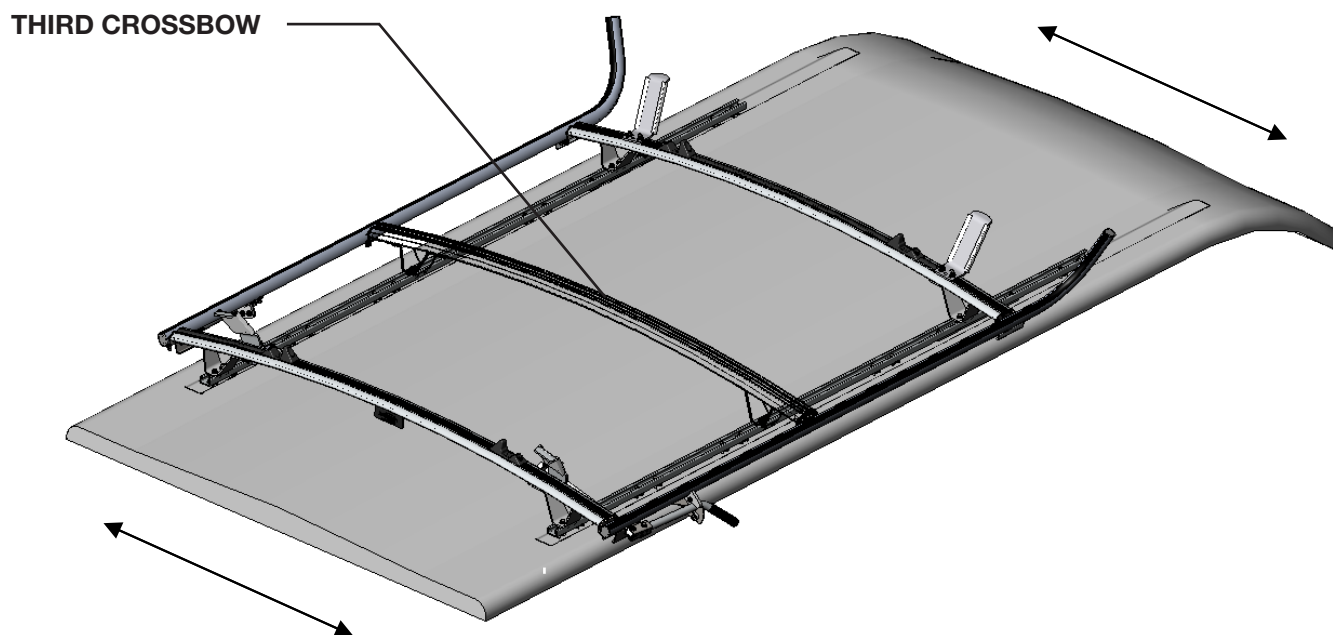

TOOLS

- Ratchet
- 1/2" Socket

2.2.4 Ladder Rack adjustment for extension ladder.

NOTE:

- Do this step on both sides.
- The ladder cannot extend beyond the rear bumper of the vehicle.

IMPORTANT:

- After installation is complete, cut the track plug underneath the crossbows to fill all the unused space.
- Place the ladder rack warning label on a visible area, recommended on a partition.

THIRD CROSSBOW

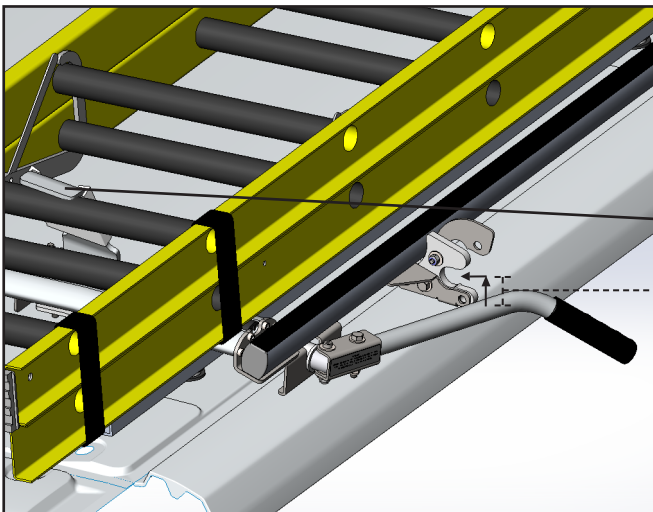
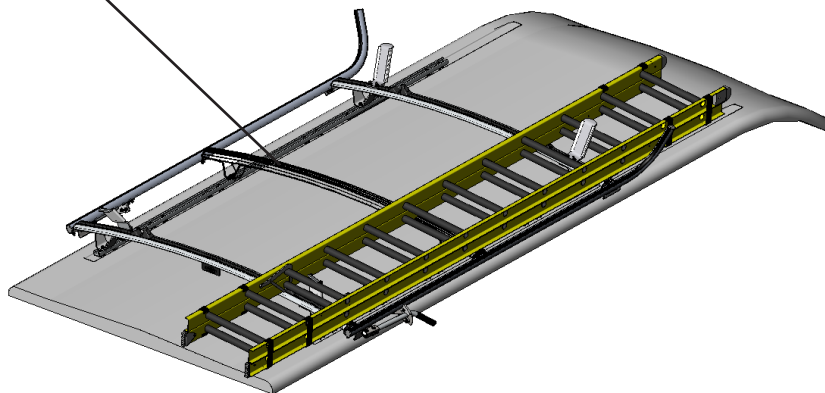

When the rear hook touches the ladder, the handle should be 1" below the ladder clamp hasp.

REAR HOOK

1"

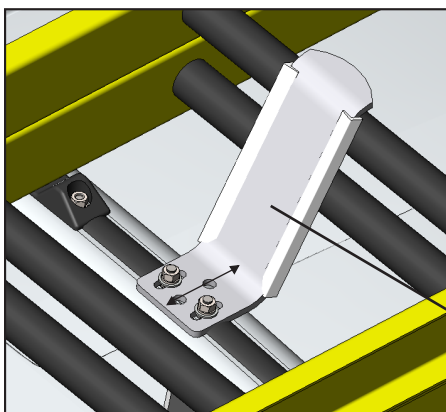

Now adjust the front hook to be snug against the ladder rung and tighten the bolts on the front crossbow.

TOOLS

- ☐ Cordless Impact
- ☐ 1/2" Socket

FRONT HOOK

PHASE 2 – INSTALLATION

2.3 NOTE

2.3.1 If the handle is interfering with the door or roof of the vehicle, the handle can be installed in an alternate position.

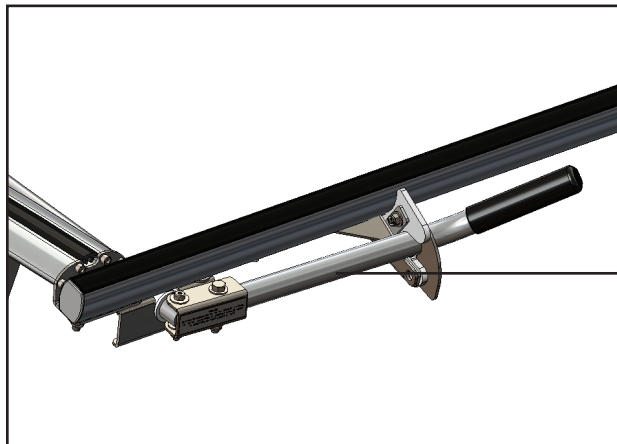
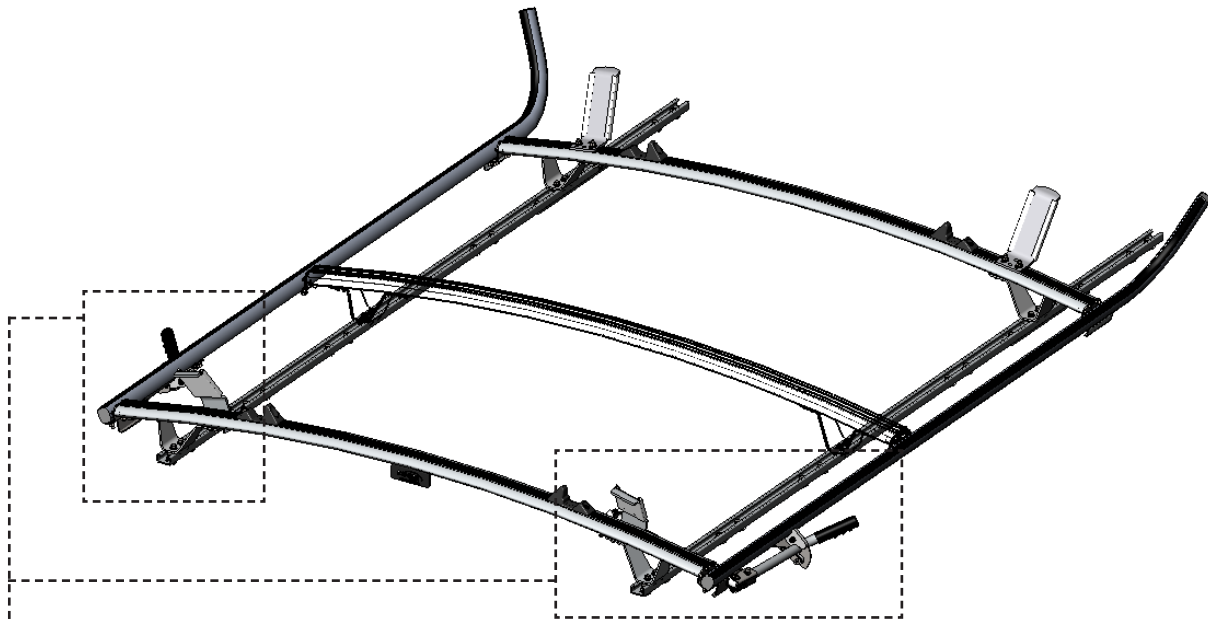

If the handle is interfering with the door or roof of the vehicle, disassemble the handle, then assemble it in an alternate position as shown.

Handle

THIRD CROSSBOW

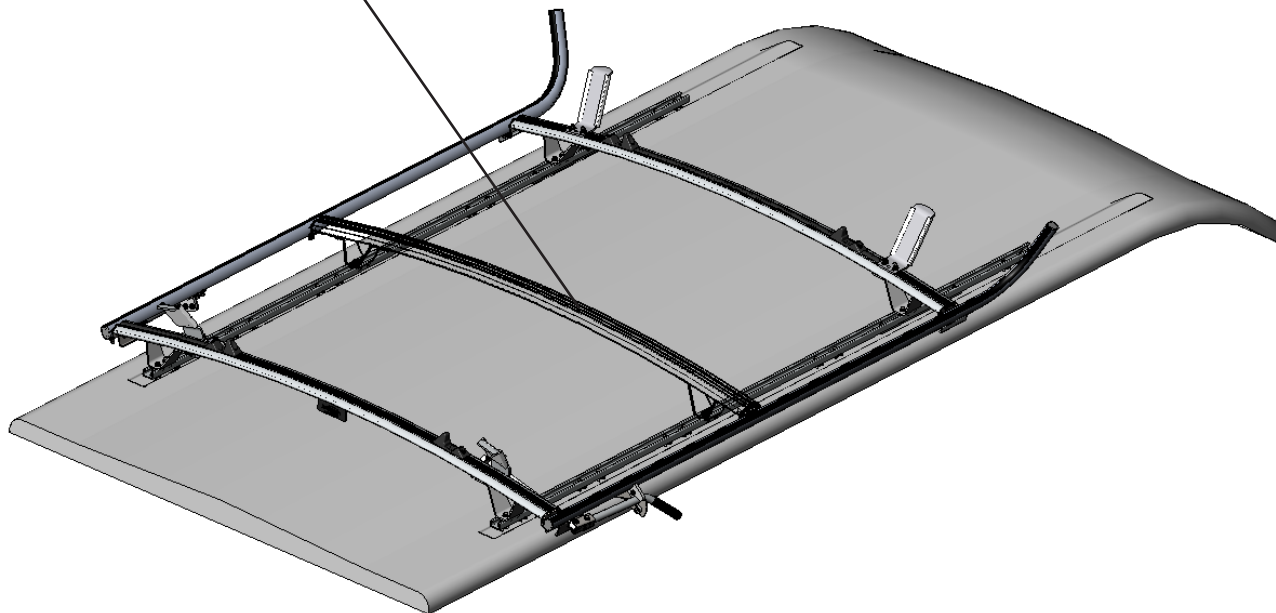

**“You have successfully installed your
Ladder Rack**

Thank you for doing business with us.”

For any feedback or suggestions you may have, please contact: cs@rangerdesign.com

